



MALETH AERO



AIRBUS A330-200

MSN 466

GENERAL AIRCRAFT DESCRIPTIONAs of: **31-Jul-22**

Aircraft Type	A330-202	Serial Number	466
Date of Manufacture	27-Jun-02	Registration	9H-JFS
TSN	59419	CSN	8194

	<u>Pounds</u>	<u>Kilograms</u>	<u>Gallons</u>
Maximum Taxi Weight	515,661	233,900	n/a
Maximum Take Off Weight	513,677	233,000	n/a
Maximum Landing Weight	401,241	182,000	n/a
Maximum Zero Fuel Weight	374,785	170,000	n/a
Operating Empty Weight	245,580	111,393	n/a
Maximum Payload (MZFW - OEW)	129,205	58,607	n/a
Fuel Capacity	245,316	111,272	36,746

AIRFRAME MAINTENANCE STATUSAs of: **31-Jul-22**

<u>Check</u>	<u>Interval</u>	<u>Last Done</u>	<u>TT @ Check</u>	<u>TC @ Check</u>	<u>Next Due</u>
C	24 Months	04-Dec-20	57956.65	7691	04-Dec-22
6Y	72 Months	04-Dec-20	57956.65	7691	04-Dec-26
12Y	144 Months	04-Dec-20	48682	6470	04-Dec-32

AVENSIS MEDIUS CONFIGURATION

<u>Cargo Hold</u>	<u>Volume (m³)</u>	<u>Payload (kg)</u>
Upper Deck	178.3	23,430
Lower Deck	123	37,578

ENGINE MAINTENANCE STATUSAs of: **31-Jul-22**

	Engine 1	Engine 2
Serial Number	811172	811227
Engine Type	CF6-80E1A4	CF6-80E1A4
Engine Thrust	68,530 lbs.	68,530 lbs.
Time Since New	54,542	32407
Cycles Since New	7338	11360
Date of Last Shop Visit	02-Jan-12	07-Jul-15
TSLSV	15051	3002
CSLSV	1992	629
Cycles Remaining	7662	3640

LANDING GEAR MAINTENANCE STATUSAs of: **31-Jul-22**

	Nose Gear	LH Main Gear	RH Main Gear
Part Number	D23581100-19	201490001	201490002
Serial Number	B644	MDL693	MDL693
Date Installed	Apr-22	Apr-22	Apr-22
Last Overhaul Date	30-Sep-19	11-Dec-18	11-Dec-18
TSO	2705	5654	5654
CSO	470	1136	1136
Next Overhaul Date	30-Sep-29	11-Dec-28	11-Dec-28

APU MAINTENANCE STATUSAs of: **03-Sep-21**

Manufacturer	Honeywell	TSN	11654	TSLSV	2935
Type/Model	GTCP331-350C	CSN	7072	CSLSV	2433
Serial Number	P-843				

CONFIGURATION

Galleys	G1 and G2	Zodiac 1021L
Lavatories	1	

ADDITIONAL FEATURES

	<u>Installed</u>	<u>Make/Model</u>	<u>Remarks</u>
Winglets	Yes		Installed per IPC 57-31-21
IFE	No		
Airshow	No		
Camera	Yes		
Audio	No		

Aircraft Technical Specification Sheet

AVIONICS - Major Avionics Equipment

ATA 22 - Automatic Flight Controls	QTY	Manufacturer	Model / Part Number
FMGEC	2	Thales	C12858BA02
FCU	1	Thales	K274AAM0608

ATA 23 - Communication	QTY	Manufacturer	Model / Part Number
HF Transceiver	2	Collins	822-0330-020
Transceiver VHF/COMM	3	Collins	822-1047-030
CIDS Director	2	Kid-Systeme	Z011H0002116
FAP Panel	1	Kid-Systeme	Z131H0733116
Fixed ELT	1	Kannad	S1819502-02

ATA 27 - Flight Controls	QTY	Manufacturer	Model / Part Number
Slat/Flap Control Computer (SFCC)	2	Diehl	84333-00-0304

ATA 31 - Indication and Recording System	QTY	Manufacturer	Model / Part Number
Flight Data Recorder	1	Honeywell	980-4700-003
Cockpit Voice Recorder	1	Honeywell	980-6022-001
FDIU	1	Sagem	ED43B1D7
DMU	1	Honeywell	967-0514-002
Printer Multi-Port FANS	1	Thales	607676-0002
MDDU	1	Sagem	AC68A100
DMC	3	Thales	96154570512X
Display Unit	6	Thales	45606112

ATA 34 - Navigation	QTY	Manufacturer	Model / Part Number
Multi Mode Receiver ILS/GPS	2	Rockwell Collins	822-1152-131
Weather Radar Transceiver	2	Rockwell Collins	622-5132-622
TCAS Computer	1	Rockwell Collins	622-8971-322
ATC-Mode S Transponder	2	Rockwell Collins	822-1338-021
Radio Altimeter (LRRA) Transceiver	2	Rockwell Collins	822-0334-020
ADIRU	3	Honeywell	HG2030AE23
MCDU	3	Honeywell	4077880-961 / -962
VOR Marker Beacon	2	Rockwell Collins	822-0297-020
DME	2	Rockwell Collins	822-0329-020
ADF	2	Rockwell Collins	822-0299-020
DDRM1 (STBY Nav)	1	Thales	63543-253-3

SPECIFICATIONS AND/OR DESCRIPTIONS ARE PROVIDED AS INTRODUCTORY INFORMATION ONLY AND DO NOT CONSTITUTE ANY REPRESENTATIONS AND/OR WARRANTIES OF AELF FLIGHTSERVICE. ACCORDINGLY, YOU SHOULD RELY ON YOUR OWN INSPECTION OF THE AIRCRAFT. ANY PROPOSED TRANSACTION IS SUBJECT TO FINAL EXECUTION OF A CONTRACT ACCEPTABLE IN FORM AND SUBSTANCE TO AELF FLIGHTSERVICE, AND/OR ITS CLIENTS, AND ITS COUNSEL.

SEAT POSITION	P/N	DESCRIPTION	MANUFACTURER	QTY PER A/C
ROW 1 - LH	869606-403	SEAT B/C MODEL 5810, LH STD DBL, 8" RECL	SAFRAN	1
ROW 1 - CTR	869606-417	SEAT B/C MODEL 5810, CTR STD TPL, 8" RECL		
ROW 1 - RH	869606-404	SEAT B/C MODEL 5810, RH STD DBL, 8" RECL		

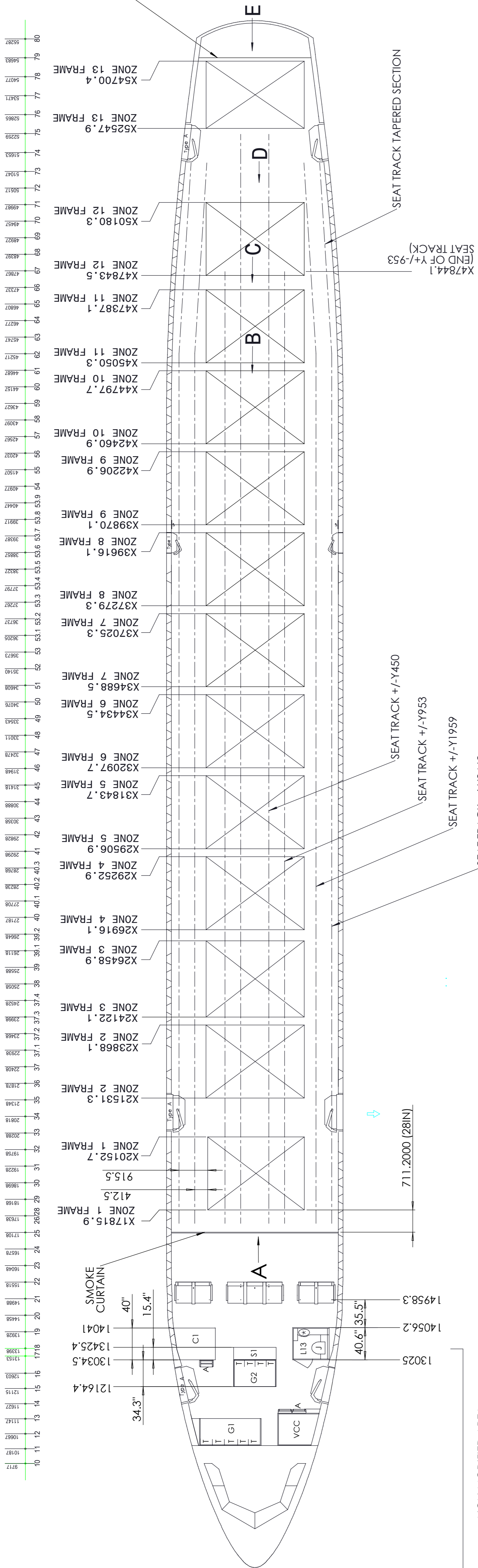

- SEAT CHARACTERISTICS AND LEGEND:
- A ATTENDANT
 - LP LITERATURE POCKET
 - △ Y/C SEATS NOT TO BE OCCUPIED AT ALL TIMES
 - G GALLEY
 - L LAVATORY
 - S STOWAGE
 - C CABINET
 - VCC VIDEO CONTROL CENTER

NON MODIFIED AREA
(EXCEPT GALLEY DEACTIVATION)

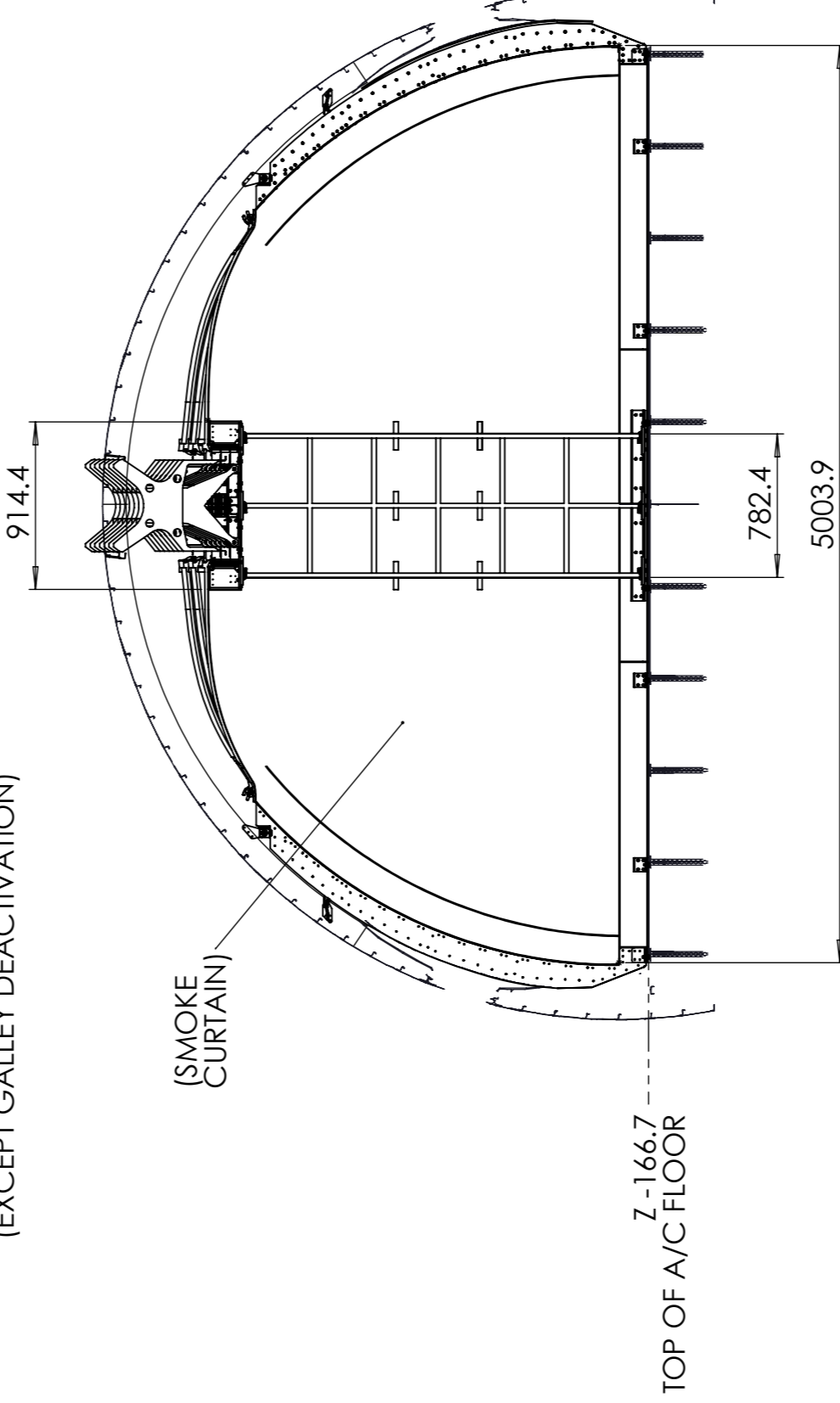

VIEW ON ARROW A
LOOKING AFT ON SMOKE CURTAIN
SCALE 1:35

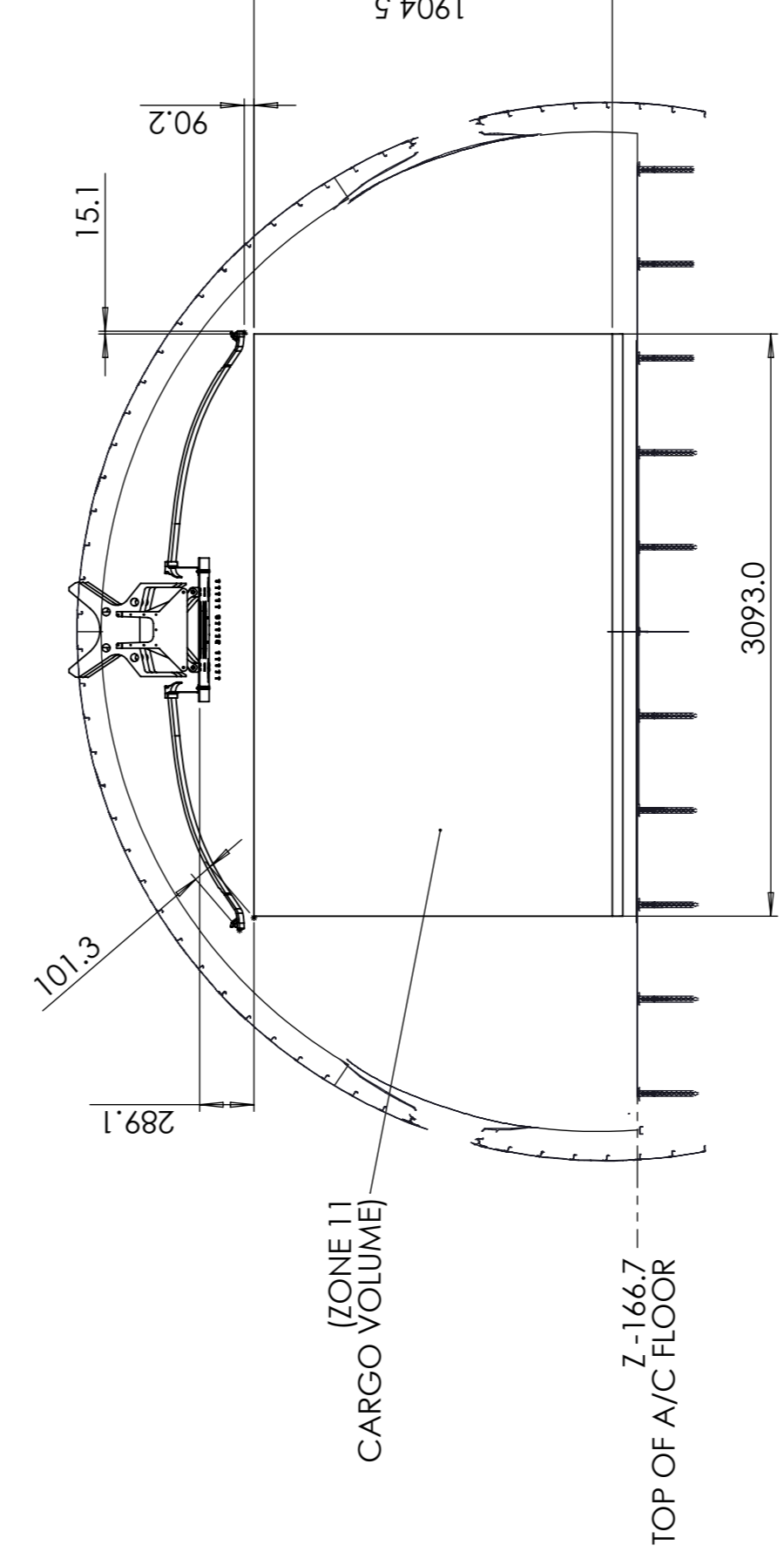

VIEW ON ARROW C
LOOKING FWD ON CARGO PALLET
SCALE 1:35

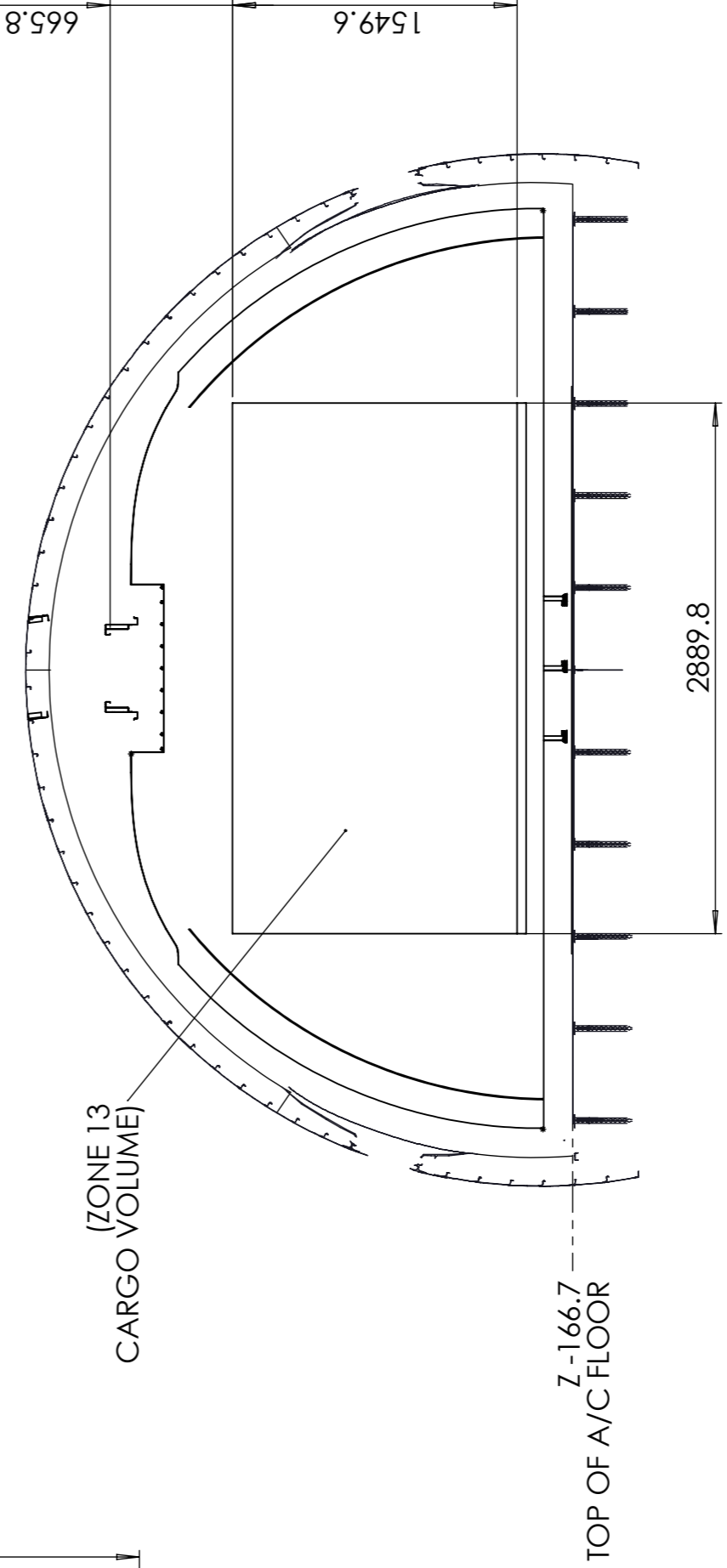

VIEW ON ARROW E
LOOKING FWD ON CARGO PALLET
SCALE 1:35

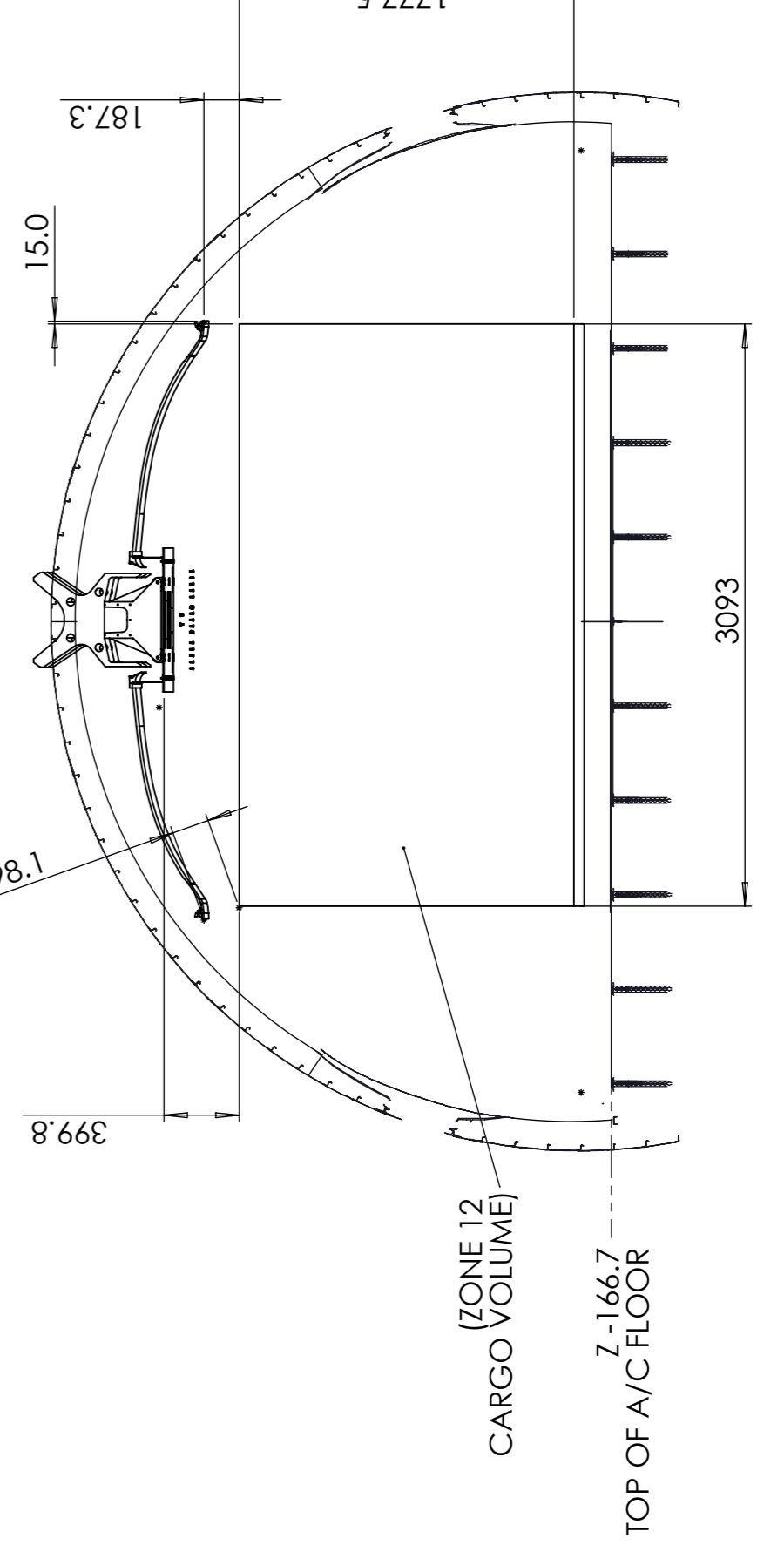

VIEW ON ARROW D
LOOKING FWD ON CARGO PALLET
SCALE 1:35

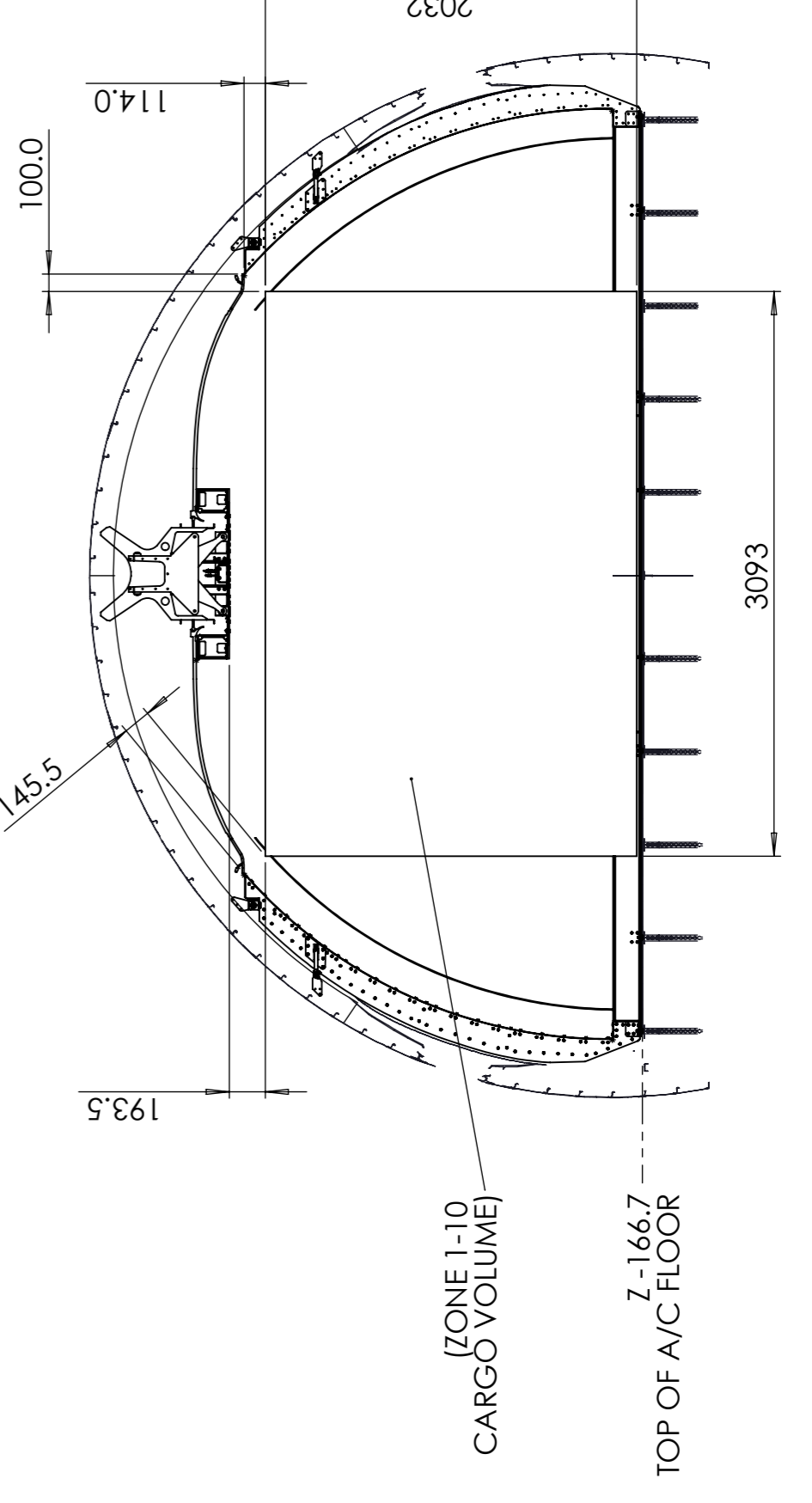

VIEW ON ARROW B
LOOKING FWD ON CARGO PALLET
SCALE 1:35

TITLE	LOPA		
PROJECT CODE	DWG SIZE	CODE IDENT NO.	ISSUE:
A332H	A1	AELF	A
SCALE	1:75	ISSUE:	2 OF 3

AVENSIS
(C) AVENSIS AVIATION LTD.
PROTECTION ACCORDING TO ISO 10016
DWG NO. **250001-002**

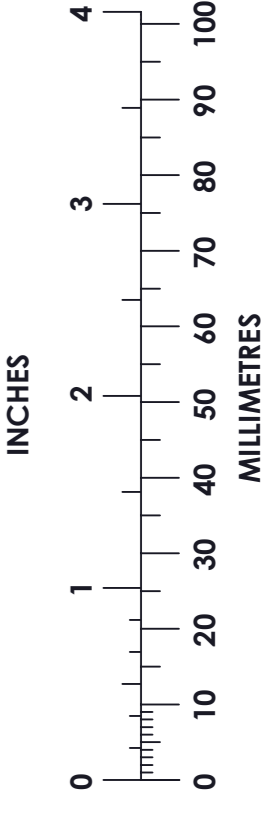

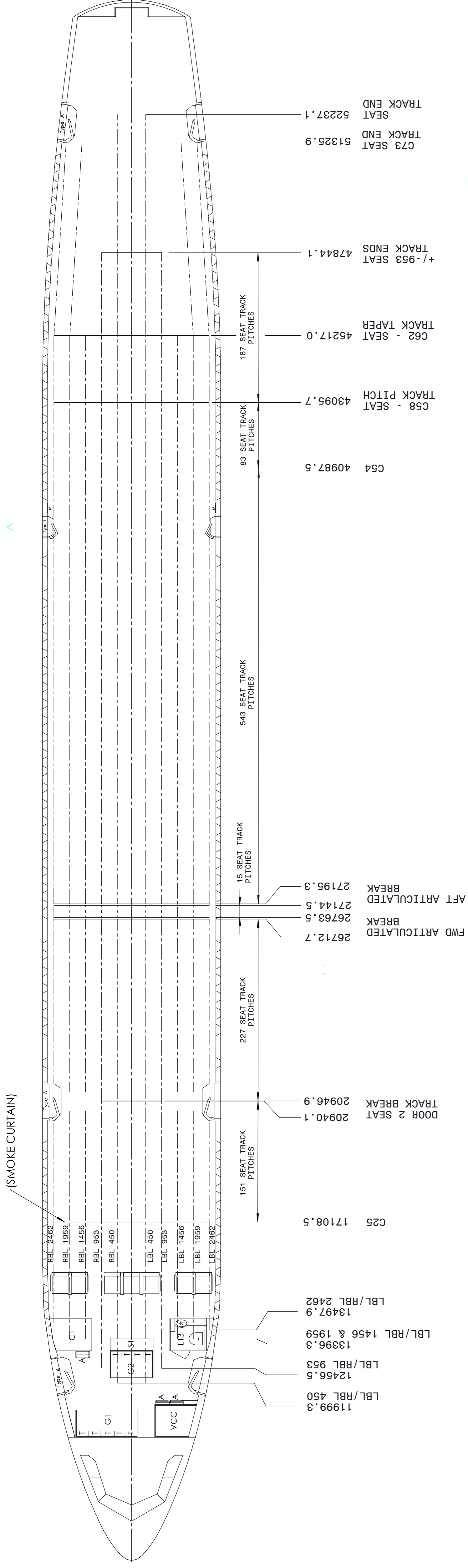

SEAT TRACK LENGTHS

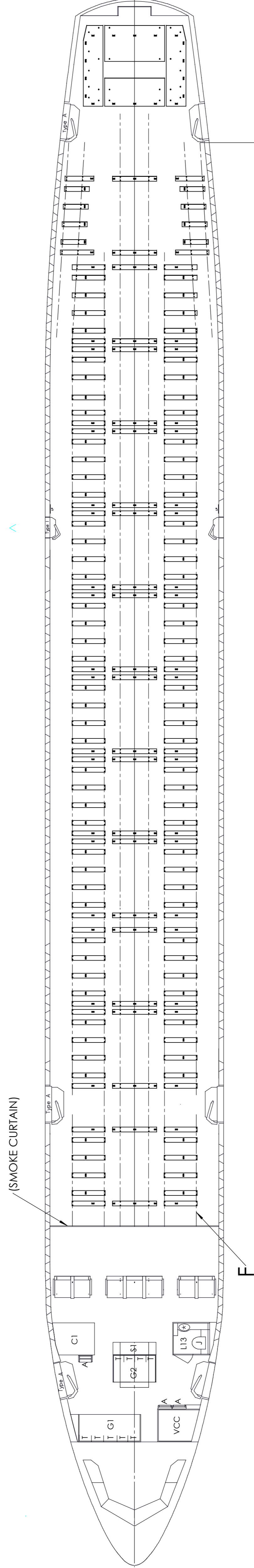

CARGO FRAME PALLETS

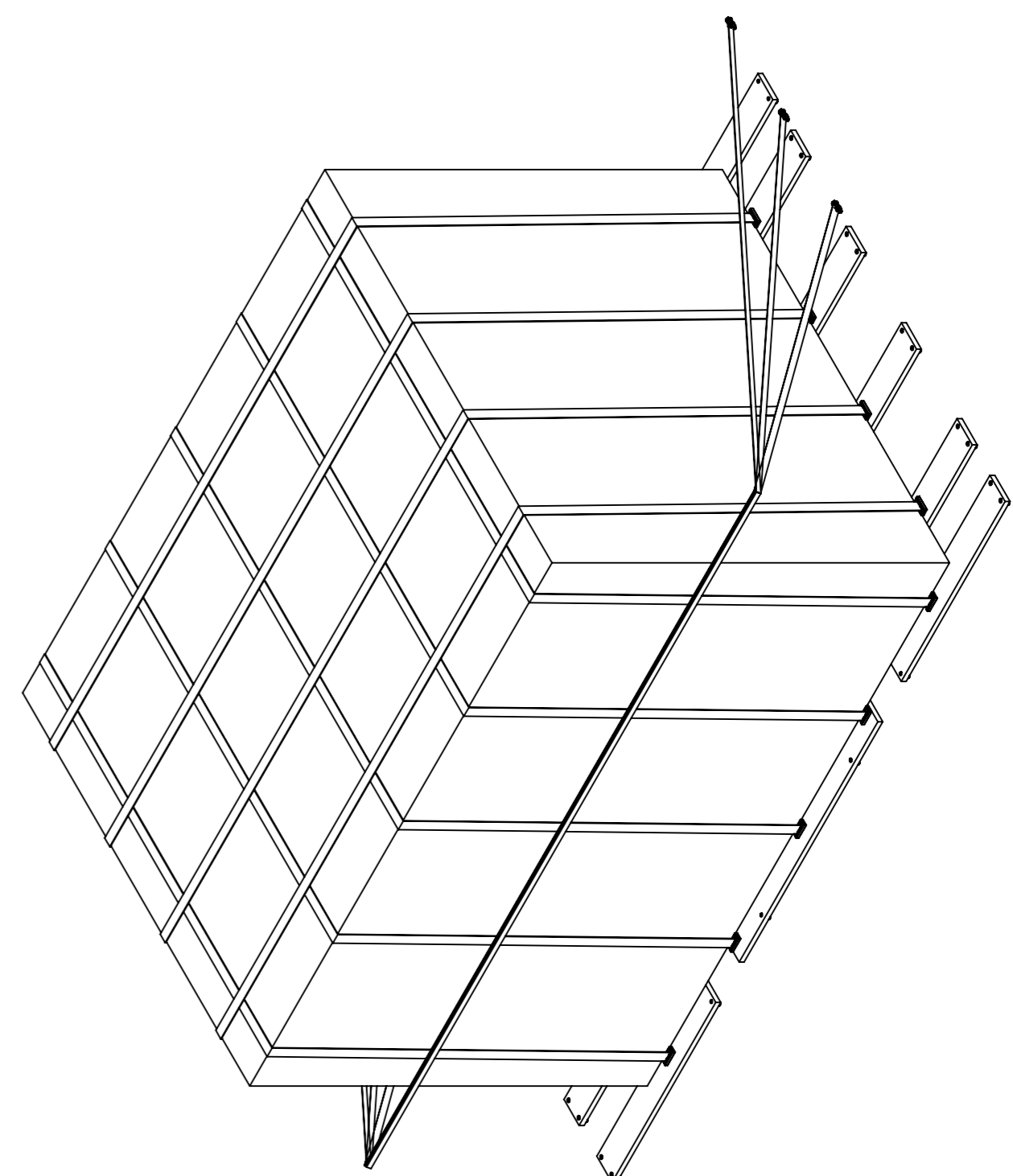

VIEW ON ARROW F
SCALE 1:25

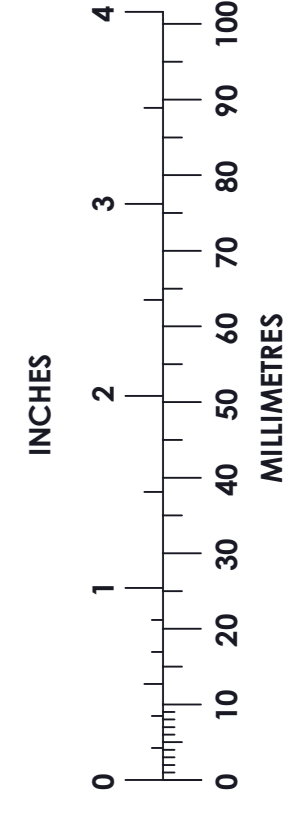

TITLE		LOPA		AVENSIS	
PROJECT CODE	DWG SIZE	CODE IDENT NO.	SCALE	ISSUE:	
A332H	A1	AELF	1:75	A	
				SHEET	3 OF 3

(C) AVENSIS AVIATION LTD.
PROTECTION ACCORDING TO ISO 140016
DWG NO. 250001-002