



your 'Solution Partner'  
in Turkey

**Dear Our Valued Customer ,**

**We are very pleased to offer our Gulfstream 4 / 16Seats**

**1989 GULFSTREAM ( Refurbished on 2017 )**

REGISTRATION (TC-GVA)



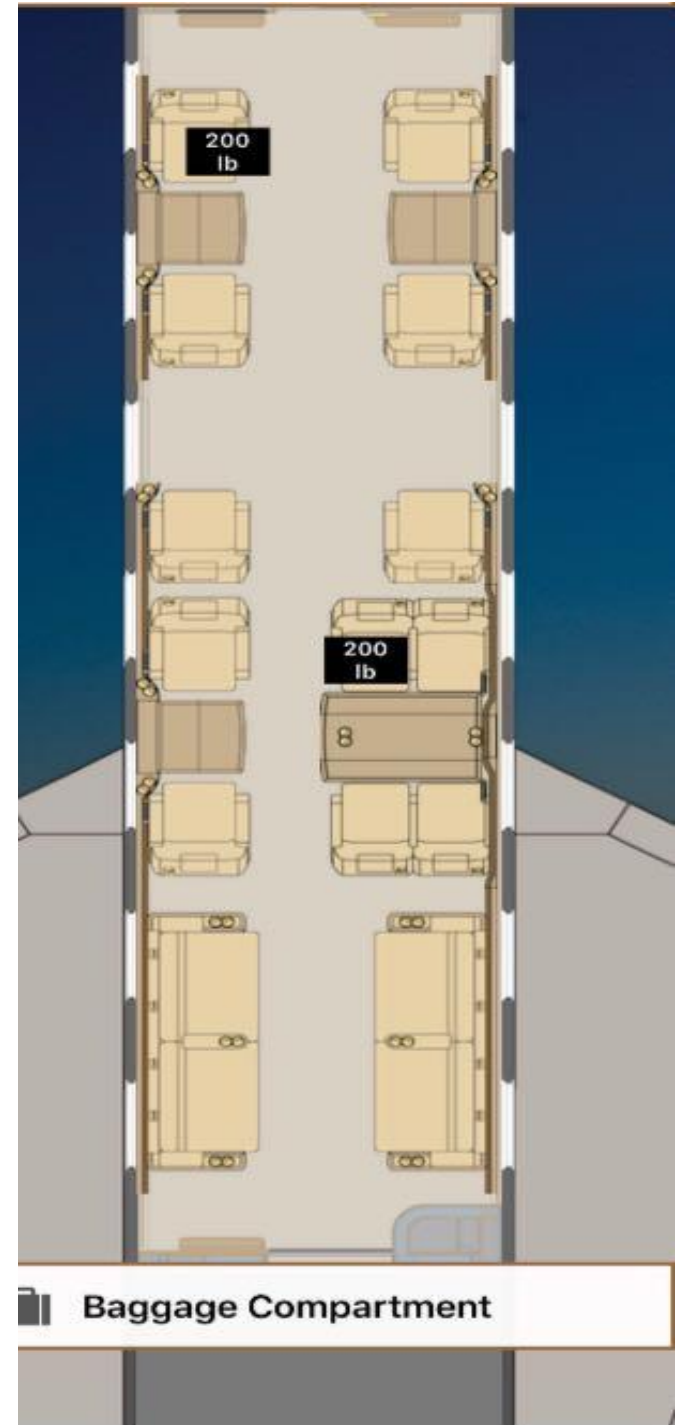

# AVIONICS

- Honeywell Primus 8000 Avionics
- A/P (Autopilot) Single Honeywell SPZ - 8000
- ADC (Air Data Computer) Dual Honeywell
- AFIS Satcom Link
- CVR (Cockpit Voice Recorder) A-100
- Wire by wire break system
- DME (Distance Measuring Equipment)
- EFIS (Electronic Flight Instrument System) DU 885
- IRU: Dual Laseref II
- GPS: Dual Honeywell 12 Chan.
- RAAS&wind –shear
- EGPWS( Enhanced Ground Proximity System)
- ELT ( Emergency Locator Transmitter)
- FMS ( Flight Management System) Triple Honeywell
- Nz2000
- HF COM ( High Freq. Communication) Dual Collins
- 728 U/ SELCAL
- NAV (Navigation Radio) Dual Collins VIR-432
- Data Loader
- RADAR ALT (Radar Altimeter) Dual Collins RT- 300
- SATCOM ( Satellite Communications) Single Honeywell
- Multi-Channel
- Wireless LAN
- TCAS (TRAFFIC Collision Avoidance System) Single
- Honeywell TCAS II
- WX Radar Single Honeywell Primus 880
- XMWeather Single Displayed on DU2 and Du5
- XPNDR (Transponder) Dual Collins TDR-94D

# INTERIOR

- Number of Passenger : 16
- Sidewall : Fabric sidewall; accordion Window Shades
- Carpet: New carpeting and covering on lower sidewall
- Refreshment Equipment : Aft galley w/sink,large oven, hot cup&coffemaker, microwave oven,
- Cabinetry : Deep high-gloss mid-cabins fold-out table,credenza,2 divans
- Entertainment Equipment : Aft entertainment system,
- 5DVD player,5triple large LCD monitors, dual 5.6 inch LCDmonitor,
- Stereo speaker system, Airshow 400
- LED lighting throughout the galley and cabin
- Two Pocket Doors; Galley/Forward cabin and mid cabin/aft cabin
- Accesories: 115 volt AC/60hz&220voltAC/ 50 he outlet
- Toilets: Forward and aft law with toilets
- Storage: Forward storage closets,
- Lavatotry Forward crew&aft