

HAWKER 800XPi



AIRCRAFT SPECIFICATIONS

CRUISE RANGE
2500 NAUTICAL MILES

CREW
TWO

CRUISE ALTITUDE
37,000 - 45,000 FT

CRUISE SPEED
459 KT

EMPTY WEIGHT
16312 LBS

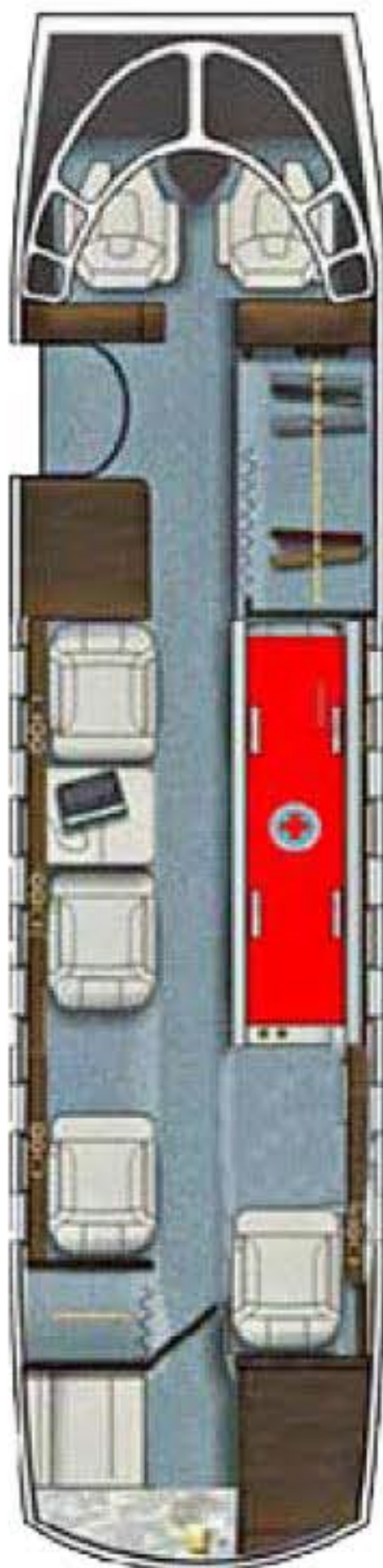

MEDICAL CAPABILITIES

PATIENTS
ONE

PASSENGER CAPABILITY
ONE PATIENT & FOUR PASSENGERS

OXYGEN CAPACITY
ONBOARD: M TANK 2000 PSI / 3500 Litres

STRETCHER
SPECTRUM AEROMED

MONITOR
ZOLL X SERIES

VENTILATOR
OXYLOG 3000 PLUS

TRANSPORT INCUBATOR
DAVID MEDICAL TI 2000