



ANTONOV AIRLINES
NO OTHER NAME CARRIES MORE WEIGHT

INDUSTRIES

HUMANITARIAN & PEACEKEEPING



INDUSTRIAL



ENERGY



OIL & GAS



MARITIME



AEROSPACE



AUTOMOTIVE



INTERMODAL



TRAINS



HELICOPTERS





Antonov AN-124-100 / AN-124-100M-150 Ruslan

Antonov Airlines was the first operator to offer the AN-124-100 ‘Ruslan’ to the commercial market. Thirty years on, as the owner and operator of seven AN-124-100s (including two modernised versions with an increased payload up to 150,000 kg (330,693 lbs), Antonov Airlines continues to set the standards.

The AN-124-100 can load shipments weighing up to 120,000 kg (264,555 lbs). However, two of Antonov Airlines’ seven AN-124-100s have been modified to accept 150,000 kg (330,693 lbs). To handle this increased weight, a new digital anti-skid braking system has been installed, together with strengthened tyres. The forward loading ramp has also been reinforced to accept heavier payloads. Designated

AN-124-100M, ‘Antonov Airlines’ modernised versions boast upgraded navigation systems (P-RNAV) and fully comply with the latest ICAO avionics and noise regulations, meaning that they can operate globally and without restriction.

The AN-124 fuselage comprises a double-deck layout. The lower deck measures 36.5 m (119 ft 9 in) in length, 6.4 m (20 ft 11 in) in width and 4.4 m (14 ft 5 in) in height. The upper deck consists of the cockpit in the forward section, and a technician/ cargo attendant’s compartment in the rear.

There is also a well-equipped living area for the crew, which is useful on long-haul flights or when operating in remote areas.

The AN-124-100 is equipped with a system of overhead cranes, which can lift single pieces weighing up to 30,000 kg (66,139 lbs), meaning that minimal ground support is required. To load single pieces weighing up to 120,000 kg (264,555 lbs), the AN-124-100 uses its specially-designed landing gear to adjust its ground angle allowing the aircraft to ‘kneel’. The AN-124-100 can then be loaded through the nose cargo door using its own extendable ramp. This method of loading can also be used to accept wheeled or tracked vehicles.



Antonov AN-124-100M-150 vs AN-124-100 – the facts:

- **Payload increased up to 150,000 kg (330693 lbs)** through reinforcement of fuselage structure, cargo floor, cargo ramp, and tyres;
- **Weight of single-piece cargo increased to 120,000 kg (264555 lbs)** following fuselage structure reinforcement and installation of nose door auxiliary supports;
- **Compliance with P-RNAV** conditions following upgrading of flight and navigation equipment;
- **Take-off weight and fuel weight increased** enhancing aircraft range;
- **Engine noise level reduced** following installation of sound-absorbing cowlings;
- **Flight range increased;**
- Reshaped nose **for better aerodynamic and fuel efficiency.**

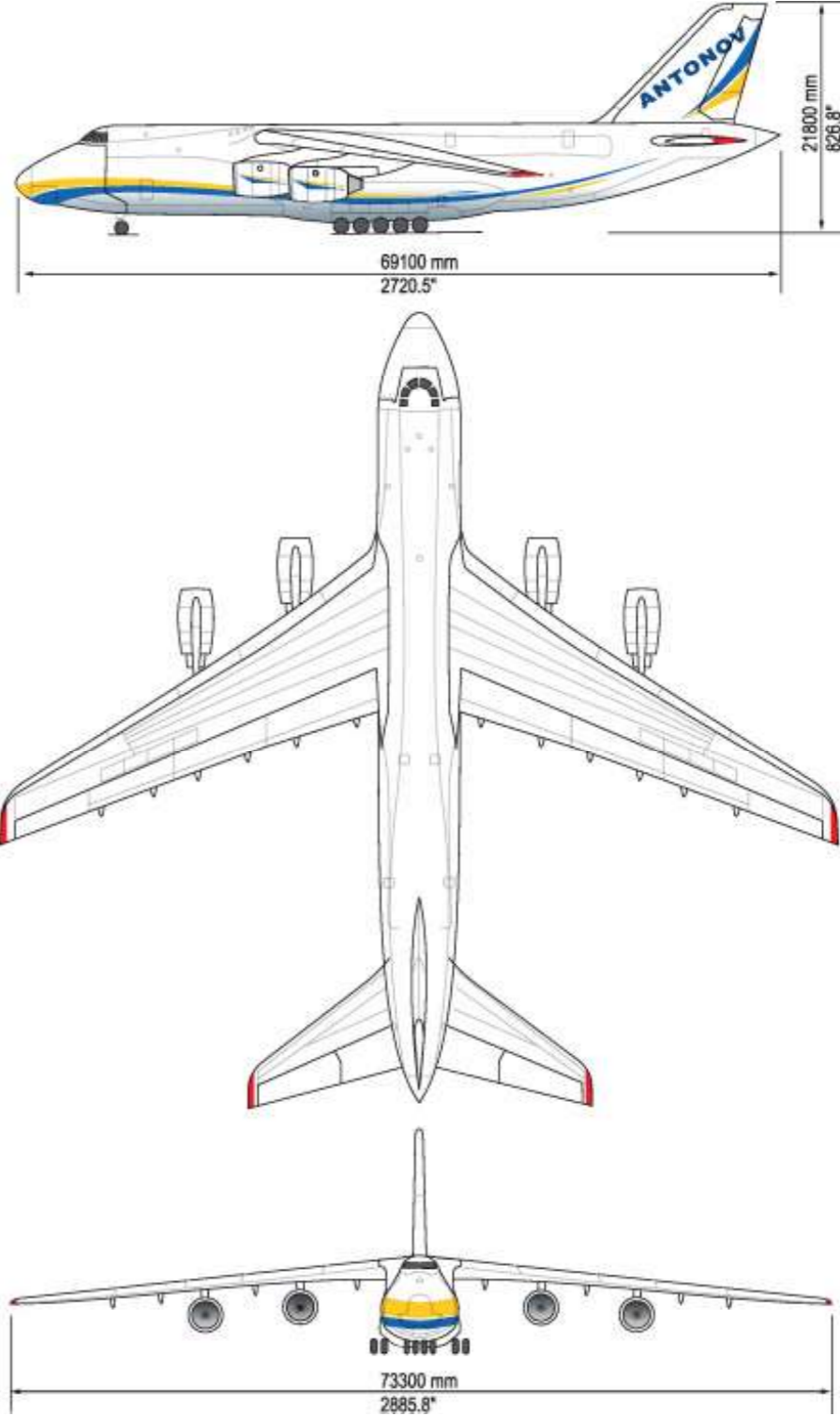

	AN-124-100	AN-124-100M-150
Maximum Payload	120,000 kg (264,555 lbs)	150,000 kg (330,693 lbs)
Maximum Volume	1,040 CBM	1,040 CBM
Cargo Cabin LWH	36.5 x 6.4 x 4.4 m (1437 x 251.9 x 173.2 in)	36.5 x 6.4 x 4.4 m (1437 x 251.9 x 173.2 in)
including Ramp	43.7 x 6.4 x 4.4 m (1877.9 x 251.9 x 173.2 in)	43.7 x 6.4 x 4.4 m (1877.9 x 251.9 x 173.2 in)
Cargo Door WH	6.4 x 4.4 m (251.9 x 173.2 in)	6.4 x 4.4 m (251.9 x 173.2 in)
On-Board Crane Lifting Capacity	30,000 kg (66,139 lbs) lift	30,000 kg (66,139 lbs) lift

Dimensions: mm (inches)

AN-124-100(M-150) Ruslan

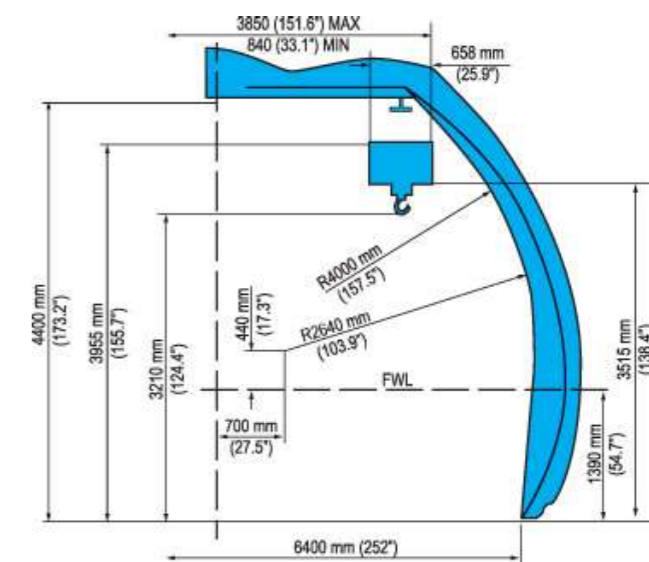
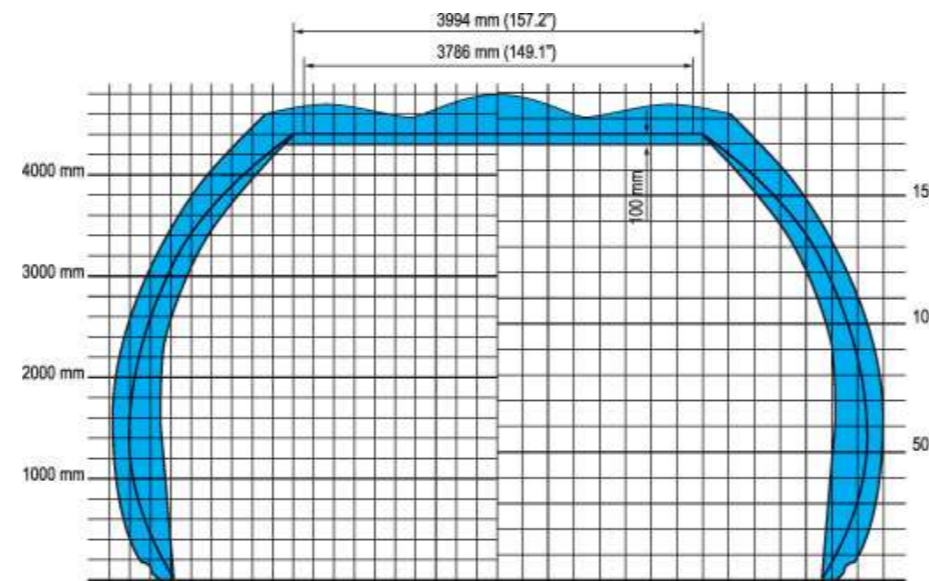
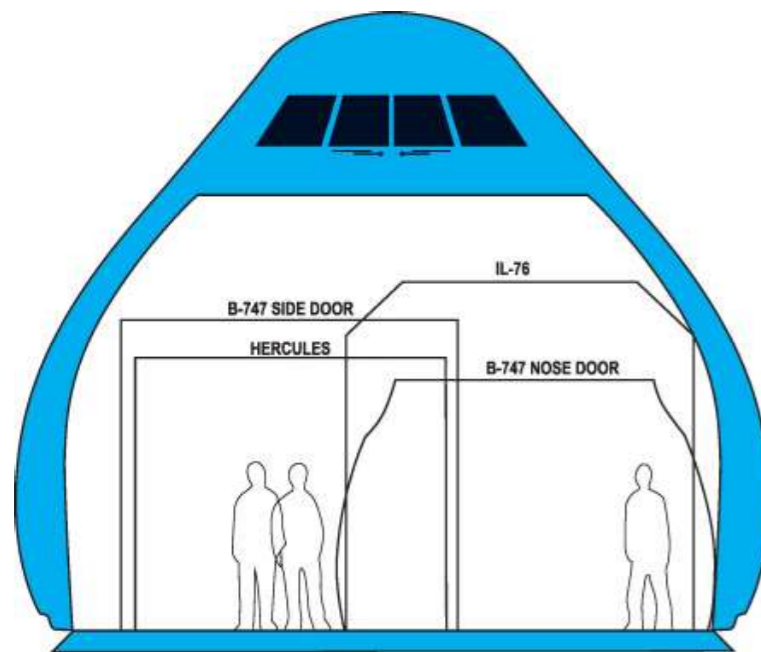
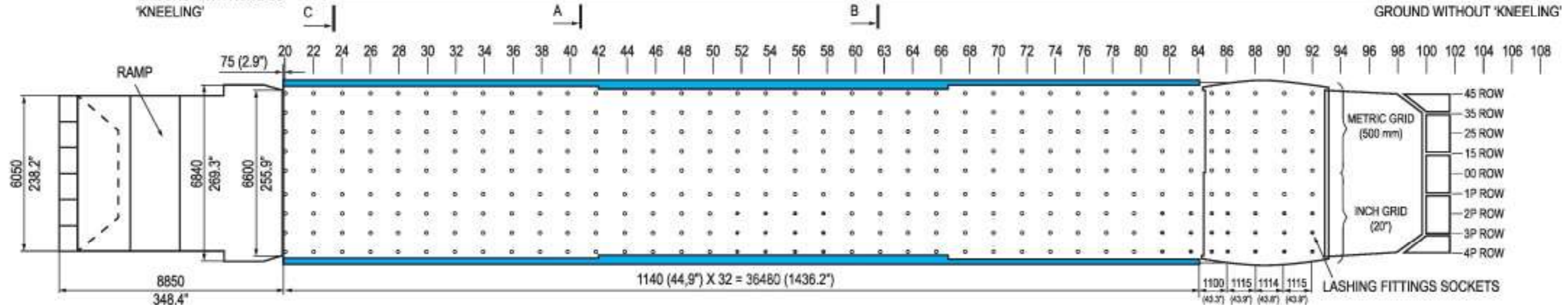
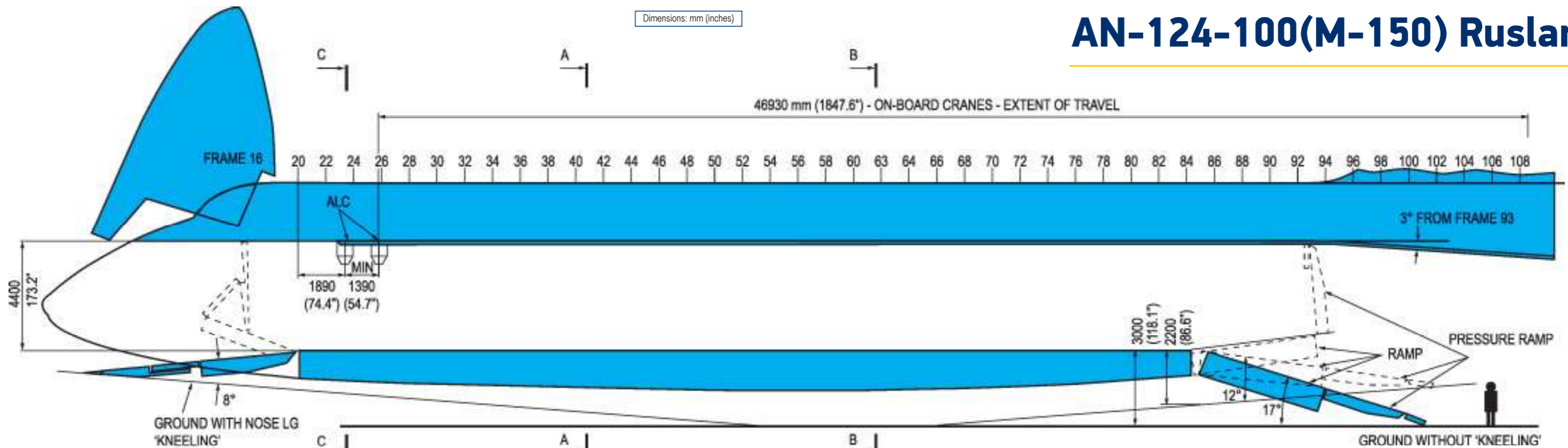



Antonov AN-225 Mriya

Antonov Airlines operates the unique AN-225 ‘Mriya’ – the world’s heaviest aircraft. Powered by six turbofan engines, this legendary aircraft has a maximum take-off weight of 640,000 kg (1,410,958 lbs).

The AN-225 was originally developed to transport the Energiya carrier-rocket and Buran space shuttle between space facilities in the former Soviet Union. It made its first flight on December 21, 1988.

The AN-225 entered commercial service in 2001. Since then, it has operated flights all over the world carrying cargoes such as transformers, generators, trains, windmill blades, compressors and other super-heavy and outsized cargoes. It also continues to support worldwide peacekeeping and humanitarian operations.

The aircraft’s service life has been extended, meaning that the AN-225 will remain in operation until at least 2033.

Based on Antonov’s AN-124 design, the AN-225 saw fuselage barrel extensions added fore and aft of the wings. The AN-225 also uses the AN-124-100’s nose gear, which allows it to ‘kneel’



‘Mriya’ – no other name carries more weight around the globe.

so that cargo can be easily loaded and unloaded. However, unlike the AN-124-100, which has a rear cargo door and ramp, the AN-225’s empennage design was changed from a single vertical stabilizer, to a twin tail with an oversized, swept-back horizontal stabilizer. This twin tail enabled the aircraft to carry large, heavy external loads, which would normally disturb the airflow around a conventional tail.

The AN-225’s cargo compartment can be pressurized, extending the

aircraft’s transport capabilities. Its onboard cargo handling equipment, plus the design of the forward cargo door and its integral ramp, also ensure quick and easy loading/unloading operations.

The AN-225 is called ‘Mriya’, meaning ‘Dream’ in Ukrainian. It has 242 world records to its name and is the inspiration for Antonov Airlines’ slogan: **“No other name carries more weight”**.

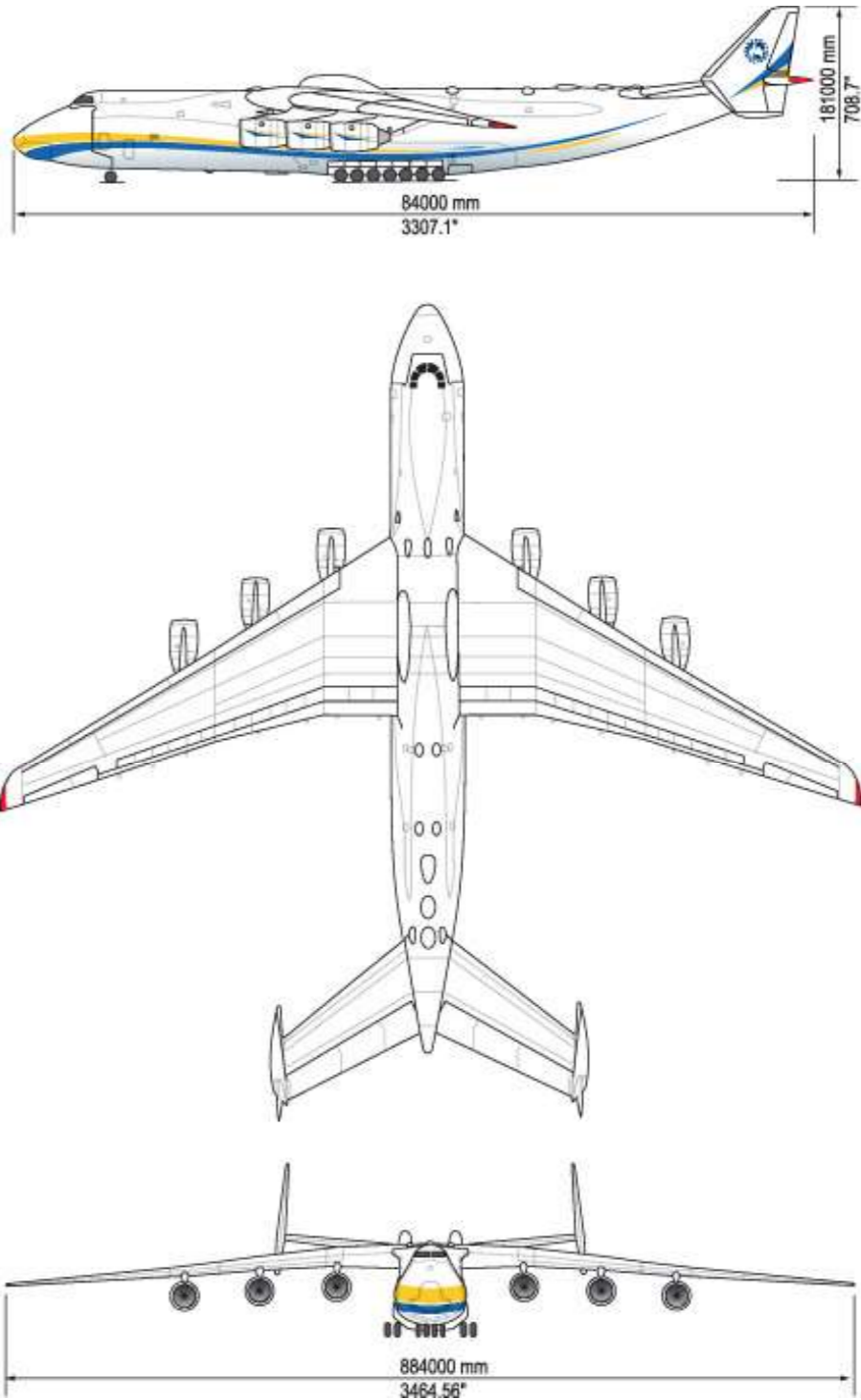

	AN-225 Mriya
Maximum Payload	250,000 kg (551,155 lbs)
Maximum Volume	1,200 CBM
Cargo Cabin LWH	43.3 x 6.4 x 4.4 m (1704.7 x 251.9 x 173.2 in)
including Ramp	45.4 x 6.4 x 4.4 m (1787.4 x 251.9 x 173.2 in)
Cargo Door WH	6.4 x 4.4 m (251.9 x 173.2 in)
On-Board Crane Lifting Capacity	30,000 kg (66,139 lbs) lift

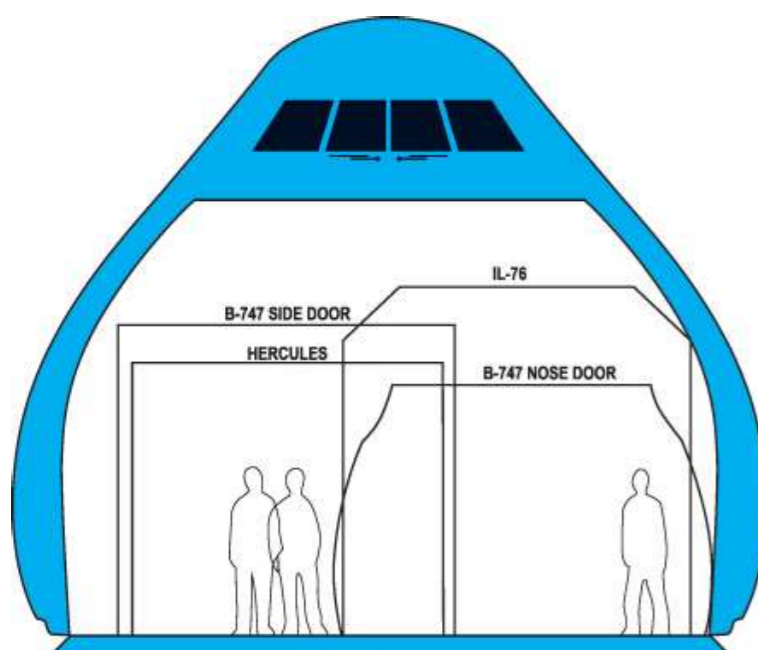

A-A

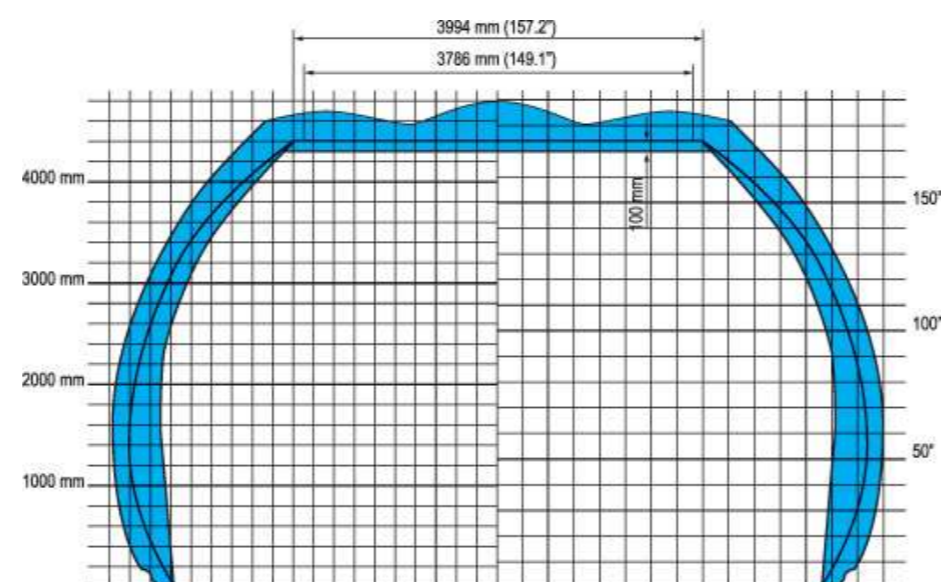

B-B

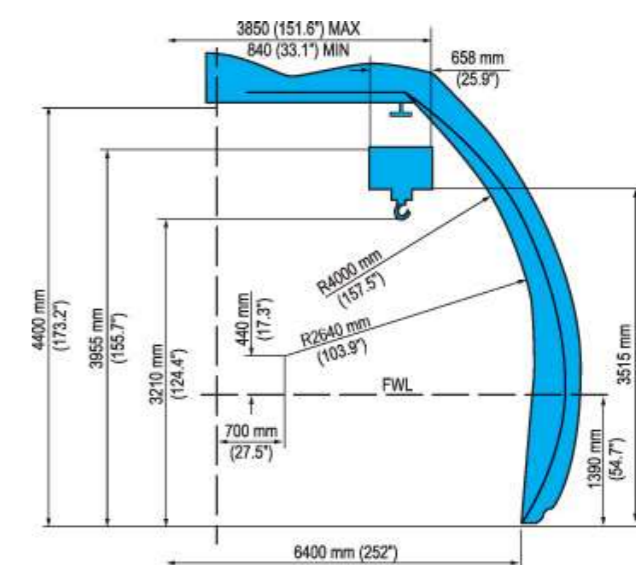

C-C



Antonov AN-22A Antei

The AN-22A ‘Antei’ is unrivalled in almost every aspect. It represents one of the key engineering achievements in aviation history.

This huge four-engine turboprop is the world's largest propeller-driven aircraft, holding a series of world records that are likely to remain unsurpassed.

The first prototype AN-22 was rolled out in August 1964. After months of test flying it made its international public debut at the 1965 Paris Air Show at Le Bourget. During its first 50 years of flying, the AN-22 set a total of 41 speed, payload and payload-to-height world records.

Originally built as a military aircraft, the AN-22’s cabin height mirrors that of the AN-124 and AN-225 – 4.4m (14 ft 5 in). Similarly equipped with an on-board crane system, the AN-22 is just as practical, yet more economical. Thanks to its unrivalled payload of 60,000 kg (132,277 lbs), the AN-22 is the only widebody freighter able to undertake the transportation of outsize cargo to remote destinations. The aircraft has the capability to operate to relatively short, unpaved airstrips. Only two airframes have ever seen commercial use. Although the AN-22A currently operated by Antonov Airlines was first built in 1974, after two years and thousands of man-hours of extensive maintenance work, the aircraft

returned to service in September 2016. This later version of the AN-22 is almost totally self-sufficient, requiring little ground support equipment thanks to its four onboard cranes with a combined capacity of 10,000 kg (22,046 lbs).

Having proved itself historically, the AN-22A is once again available for global transport duties. This aircraft provides a cost-effective alternative to cargo shipments that have traditionally been flown by jet aircraft such as the IL-76 and B747F. The unique AN-22A, however, remains the only method of air transportation for 60,000 kg (132,277 lbs) shipments to some of the world’s remotest regions.

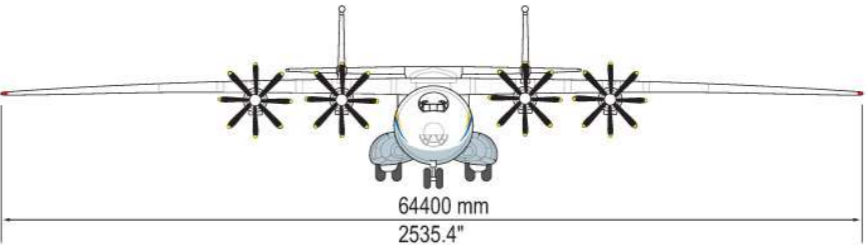
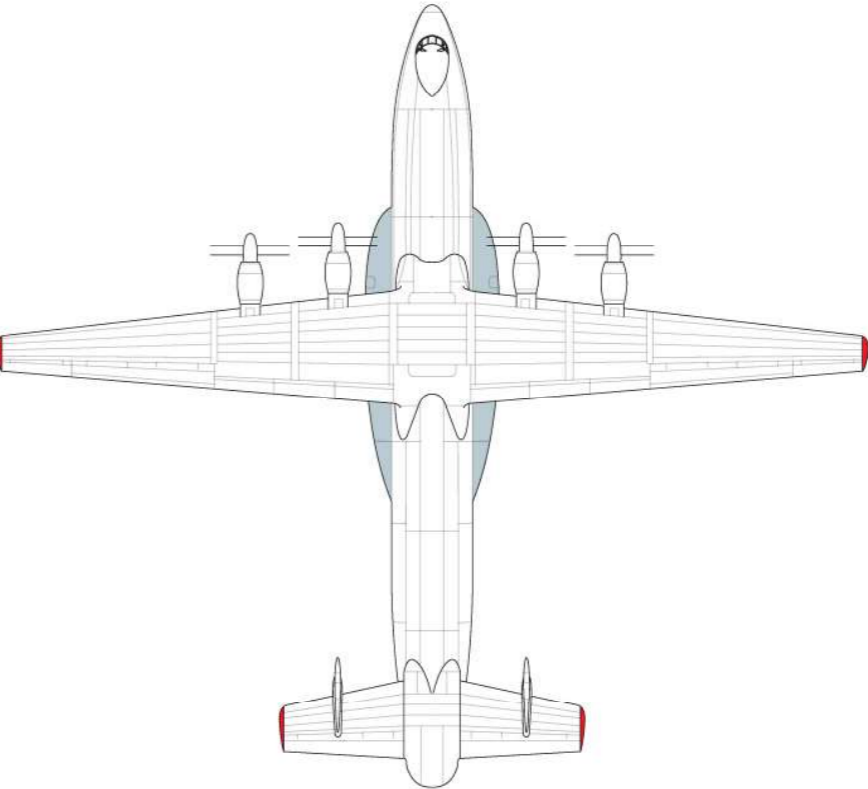
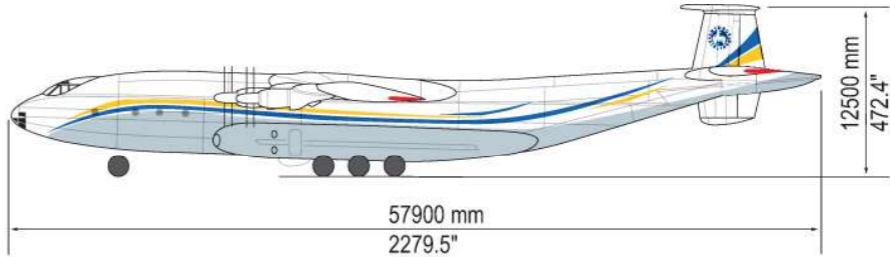

	AN-22A Antei
Maximum Payload	60,000 kg (132,277 lbs)
Maximum Volume	550 CBM
Cargo Cabin LWH	26.4 x 4.4 x 4.4 m (1039.37 x 173.2 x 173.2 in)
including Ramp	32.7 x 4.4 x 4.4 m (1287.4 x 173.2 x 173.2 in)
Cargo Door WH	4.4 x 4.4 m (173.2 x 173.2 in)
On-Board Crane Lifting Capacity	10,000 kg (22,046 lbs) lift

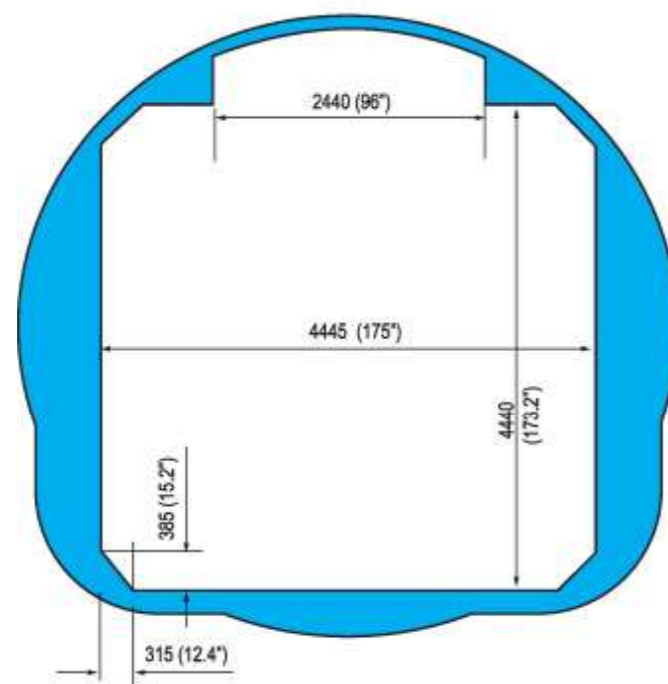

Technical drawing of the bottom view of a rectangular structure with rounded corners. The drawing includes the following dimensions:

- Overall width: 2440 (96")
- Overall height: 4400 (173.2")
- Distance between vertical centerlines: 4400 (173.2")
- Distance between horizontal centerlines: 3885 (152.9")
- Radius of the bottom-left corner: 140 (5.5")
- Radius of the bottom-right corner: 150 (5.9")
- Radius of the top-left corner: 120 (4.7")

B-B



Loading of oversized and super heavy cargoes with weight up to 200,000kg (440,000lbs) – using OPTG-120M loading equipment and external cranes

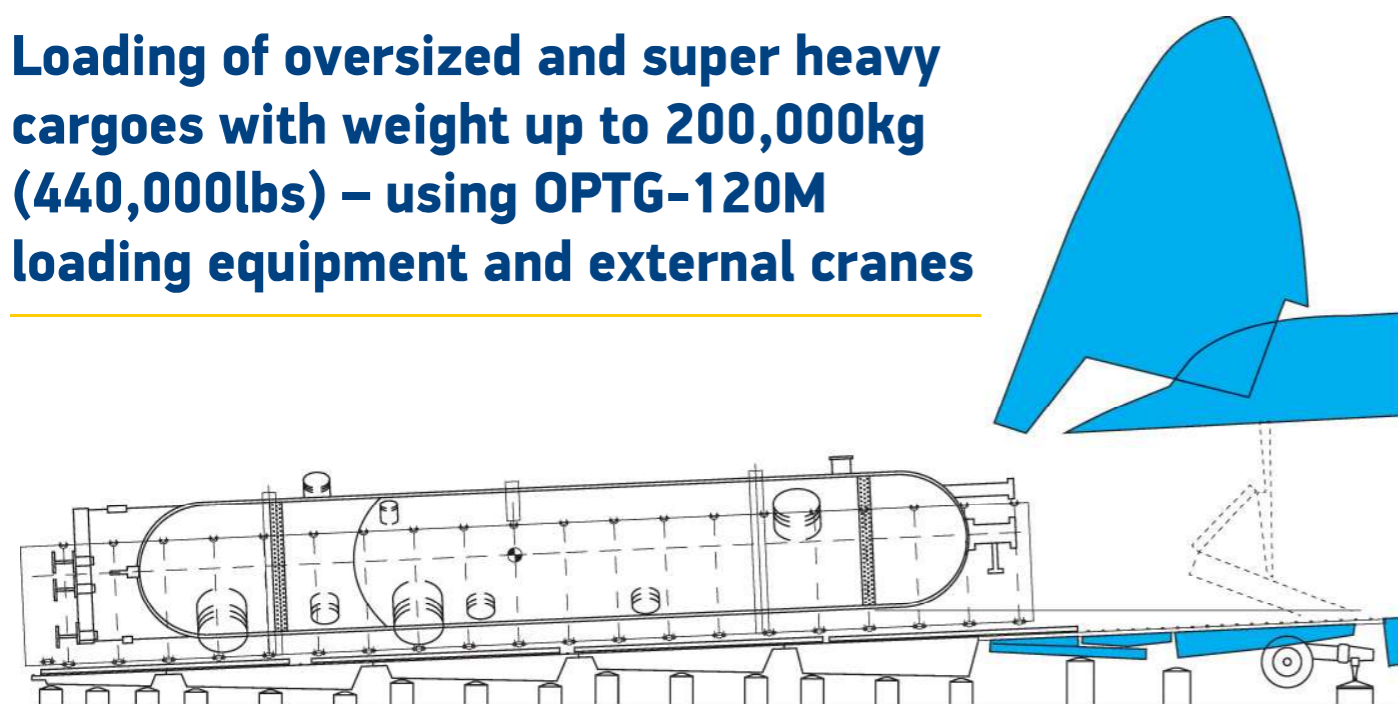

The **OPTG120** ramp system is the strongest and most rigid ramp system on the market. It has been designed and manufactured by Antonov Airlines to load heavy and oversized pieces.

Advantages of the OPTG120 ramp system:

- Lightweight and easily transportable;
- Allows easy inspection during loading process;
- Anchored to the floor after installation;
- Track size is adjustable;
- Lashing/anchoring points on both sides;
- Winching points/joint points available;
- In excess of 17 m (55 ft 9 in) clearance of the external part. Suitable for any type of container. Can be extended if necessary;
- Fully adjustable: can be used simultaneously with standard platforms (0.23 6m [9.3 in] from the aircraft floor) and low platforms (0.141 m [5.5 in] from the aircraft floor).

The **OPTG120** ramp system is used in the transportation of heavy pieces on the AN-124-100/150M and AN-225 aircraft. It allows the loading and unloading of single cargo with a maximum weight of 200,000 kg (440,000lbs) (for AN-225) and height of 4.10m (13 ft 5 in) (both AN-225 and AN-124).





Loading of tall pieces with height up to 4.27 m (168 in) – using OPKG-50 loading equipment and external cranes.

The **OPKG-50** ramp system is a unique, low profile skate-type loading equipment intended for loading and offloading oversized cargo weighed up to 50,000 kg (110,231 lbs) into the AN-124-100/150M and AN-225 aircraft. Although the system is similar to the OPTG-120M ramp system, it allows the loading of higher, but lighter pieces. However, the loading concept is the same as the OPTG-120M ramp system.

OPKG-50 'Next Generation' Ramp System:

- Lowest profile on the market – 0.08 m (3.15 in);
- Wide track size – 5.502 m (18 ft 6 in);
- Length – 25 m (82 ft);
- Brackets can be dismantled, allowing greater space between packed ramp and containers.

Cargo parameters restricted to the following limits:

- single cargo weight – 50,000 kg (110,231 lbs);
- max height 4.27 m (14 ft 1 in);
- weight per running meter up to 3600 kg (7,937 lbs);
- cargo footprint must be flat for proper weight distribution.

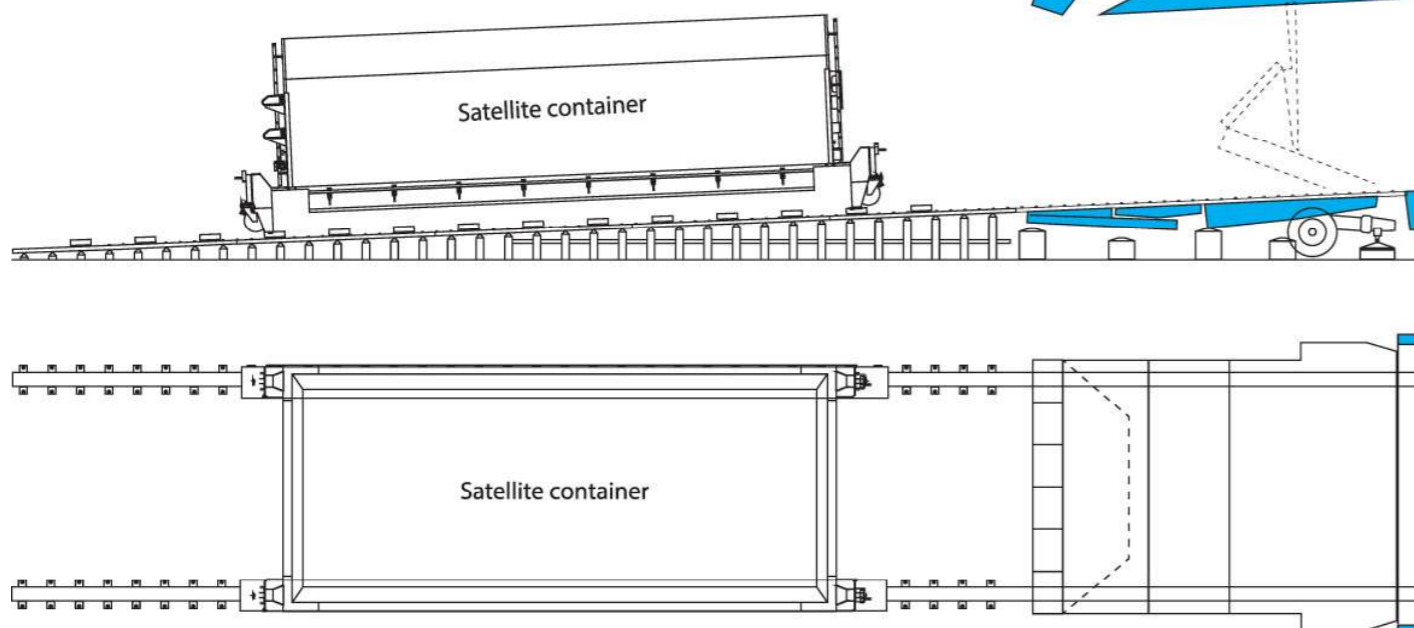
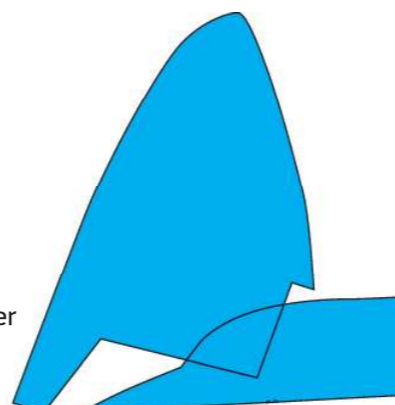



Loading of vehicles with low ground clearance – using OZDKG loading equipment

The **OZDKG** ramp is a special piece of external equipment intended for loading and offloading long and heavy-wheeled vehicles into the AN-124-100(M-150) and AN-225 aircraft. Generally used when parameters like length, road clearance and the weight of vehicle will not allow loading via the aircraft's own integral ramp.

Basic parameters:

- maximum weight of vehicle 120,000 kg (264,558 lbs);
- approach and departure angles to be no less than 5°;
- maximum axle load weight 15,000 kg (33,069 lbs).

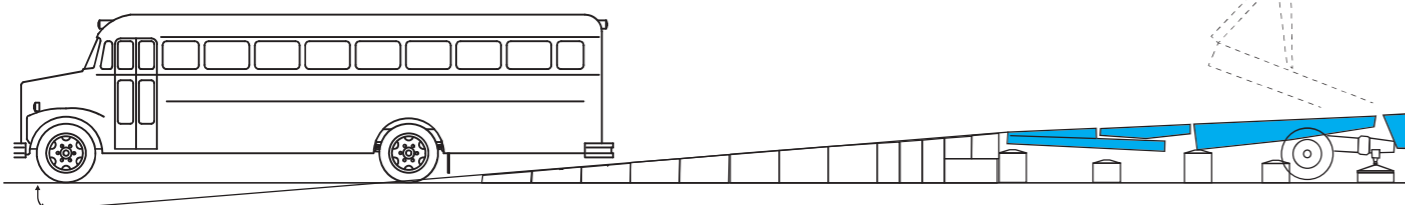



Loading of cars – using car rack system

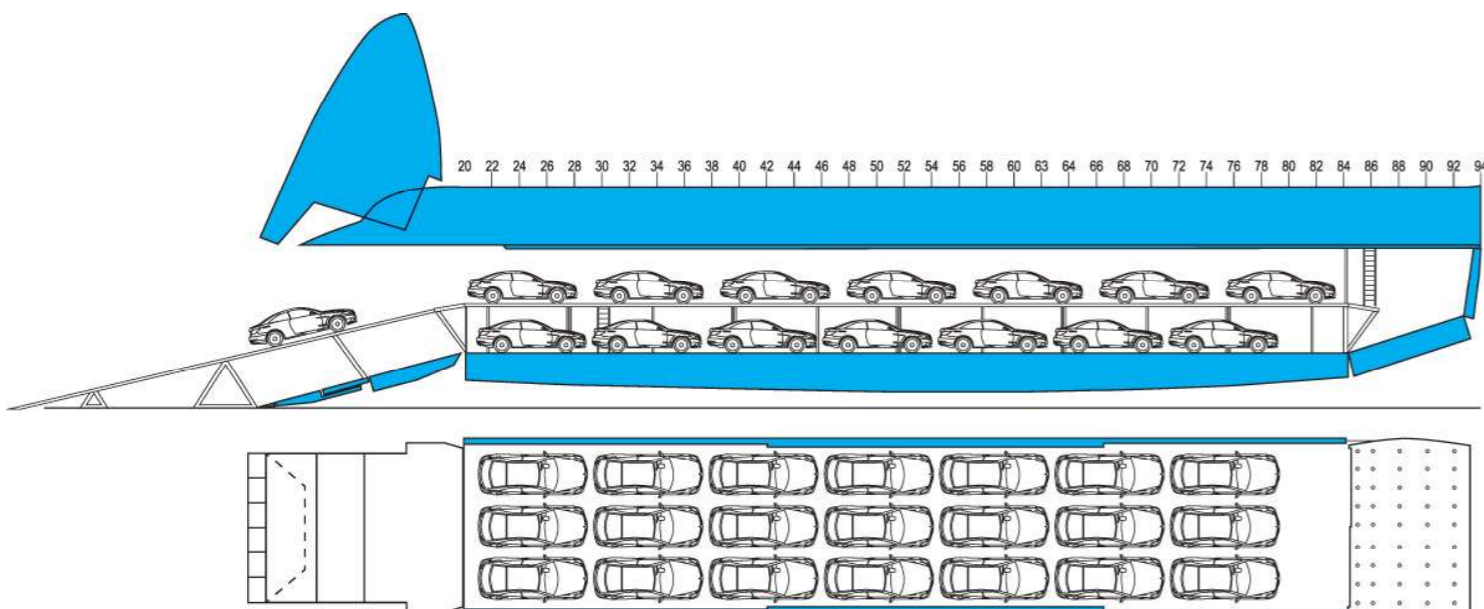

Antonov Airlines' **Car Rack System** is a special double-deck loading system allowing up to 50 cars to be loaded on two levels. Subject to vehicle dimensions and weight, cars can simply be driven onboard.

The AN-124-100(M-150) has the unique ability to adapt its floor loading capacity for the transport of multiple vehicles.

The use of the double-deck loading system means that twice the floor area can be used for the accommodation of vehicles such as saloons, rally cars and certain types of 4 x 4s.

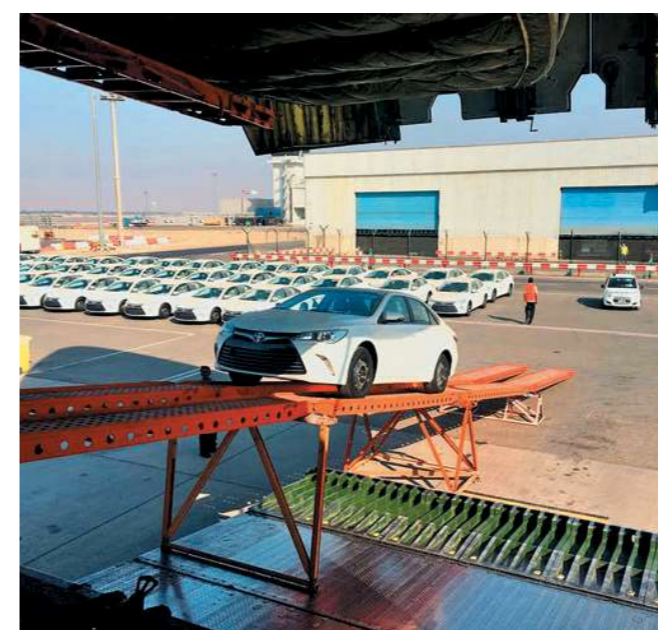
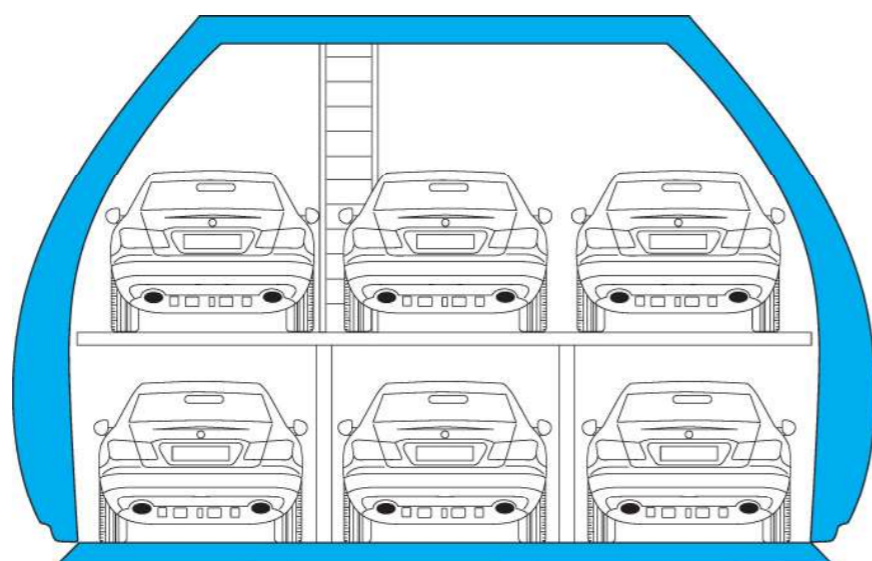



Loading of cargoes with weight up to 30,000 kg (66,139 lbs) using aircraft internal cranes via rear cargo

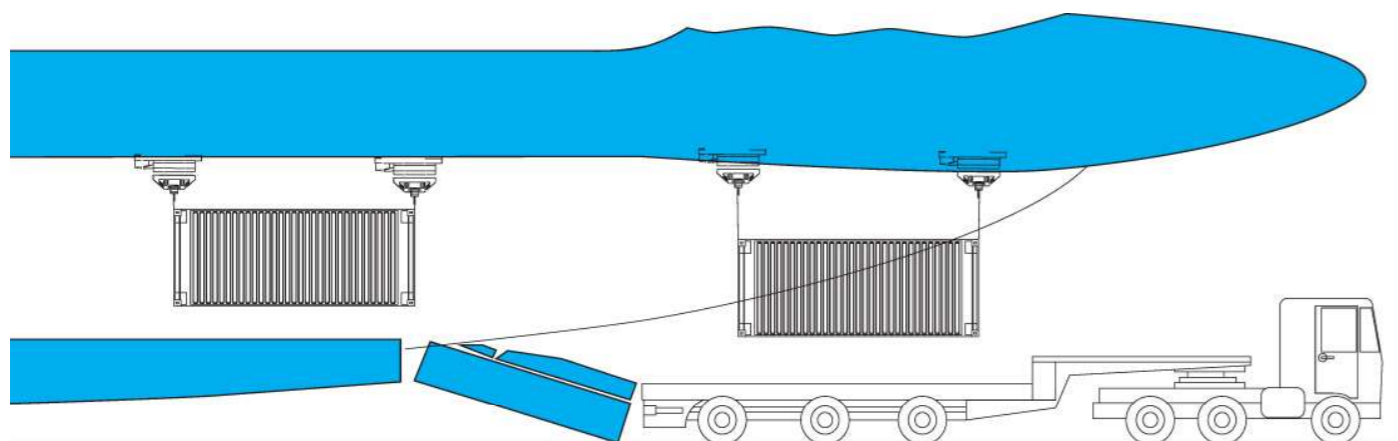

Both the AN-124-100(M-150) and AN-225 aircraft contain an onboard crane system designed and utilized for the loading and unloading of single pieces weighing up to 30,000 kg (66,139lbs).

Cargo can be delivered to the aircraft's rear cargo door on trailers/trucks, from which it can be lifted by the aircraft's bridge cranes using four hooking points. The AN-22A also contains an onboard crane system capable of lifting pieces weighing up to 10,000 kg (22,046 lbs).

Cargo loaded by this method must have suitable lifting points and a balanced CoG (Centre of Gravity) to safely load such pieces.





Loading using aircraft winches

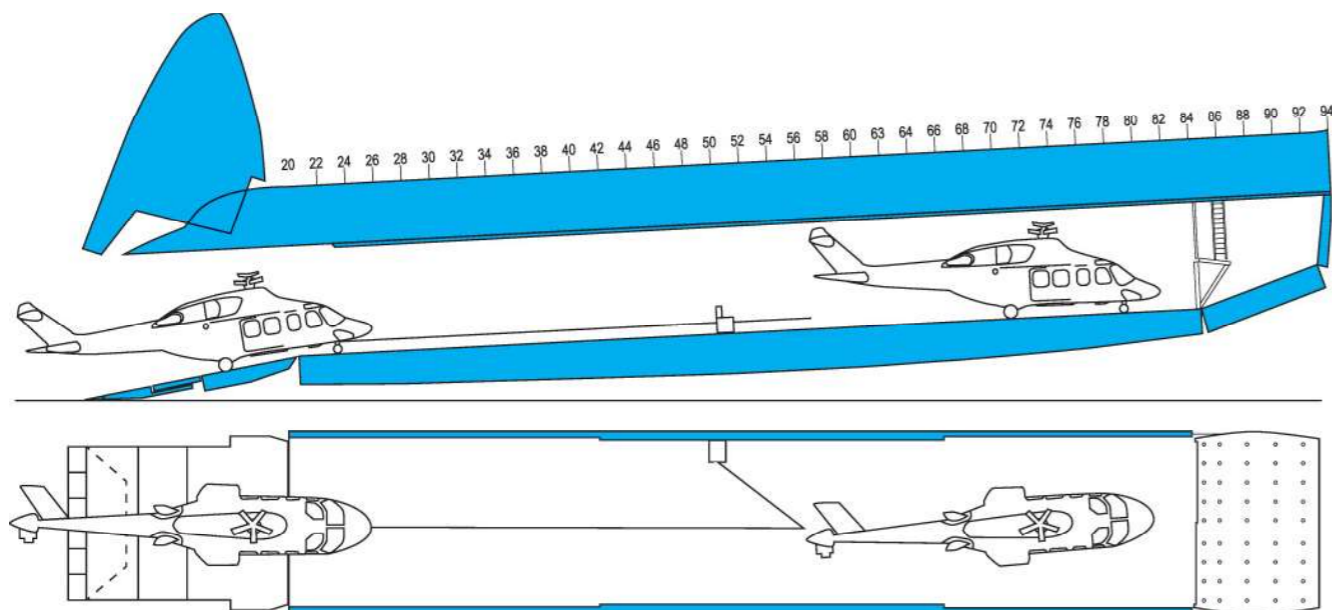

Both the AN-124-100(M-150) and AN-225 aircraft contain an onboard winch system capable of handling single pieces weighing up to 120,000 kg (264,555 lbs) AN-124-100(M-150) and 200,000 kg (440,000 lbs) (AN-225).

Generally used in conjunction with a ramp system and external cranes, the aircraft's onboard winch system is arranged using a loading pulley block system depending on the weight of item to be loaded.





Loading via nose and rear cargo ramps

Loading of self-propelled vehicles via nose and rear cargo ramps is the simplest method of loading the AN-124-100(M-150) and AN-225 aircraft.

The aircraft nose door is opened, the aircraft 'kneels', its ramp is unfolded, and vehicles are simply driven into the cargo hold.

Loading can be carried out through the nose cargo door and offloading via the rear cargo door.

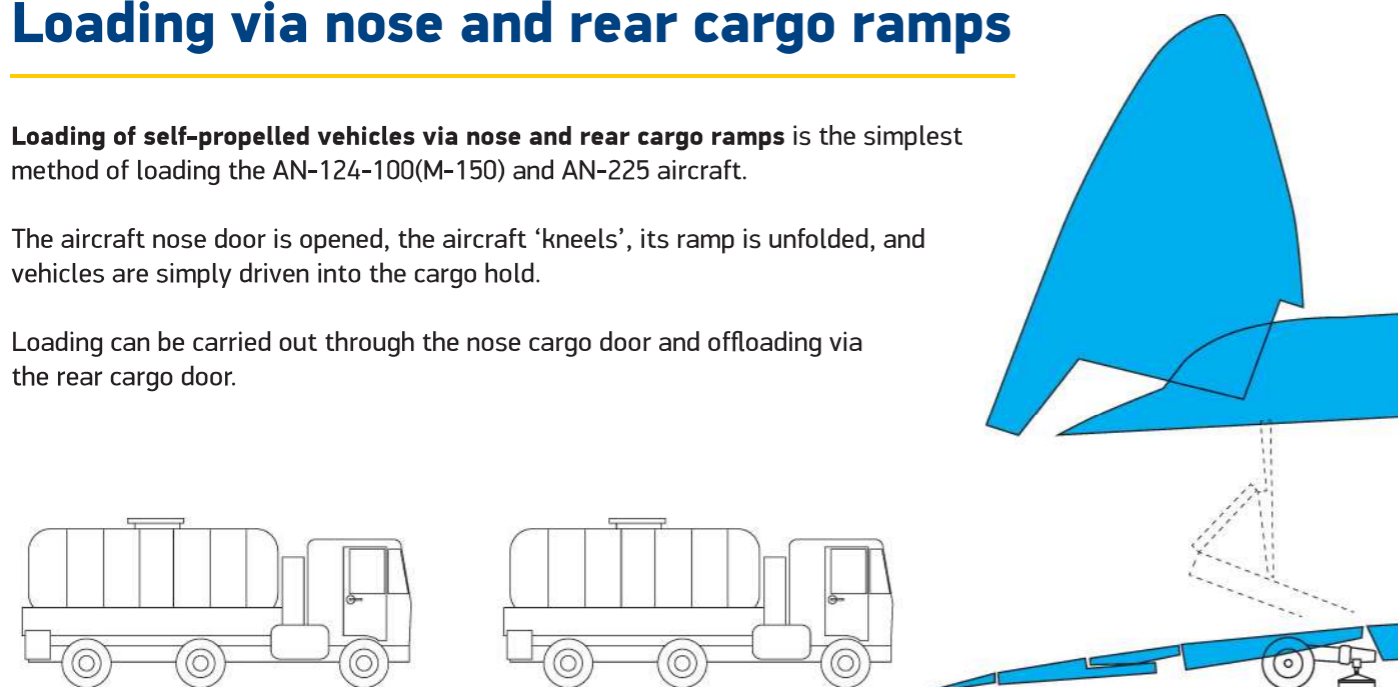



Loading of general cargo using forklift

Loading of general cargo using forklift – another simple method of loading. Forklifts can be used for loading and offloading of wooden pallets, small crates and similar items through the nose cargo door. Forklifts are not the property of Antonov Airlines and are not carried on our aircraft, but they can be provided locally with prior notice.

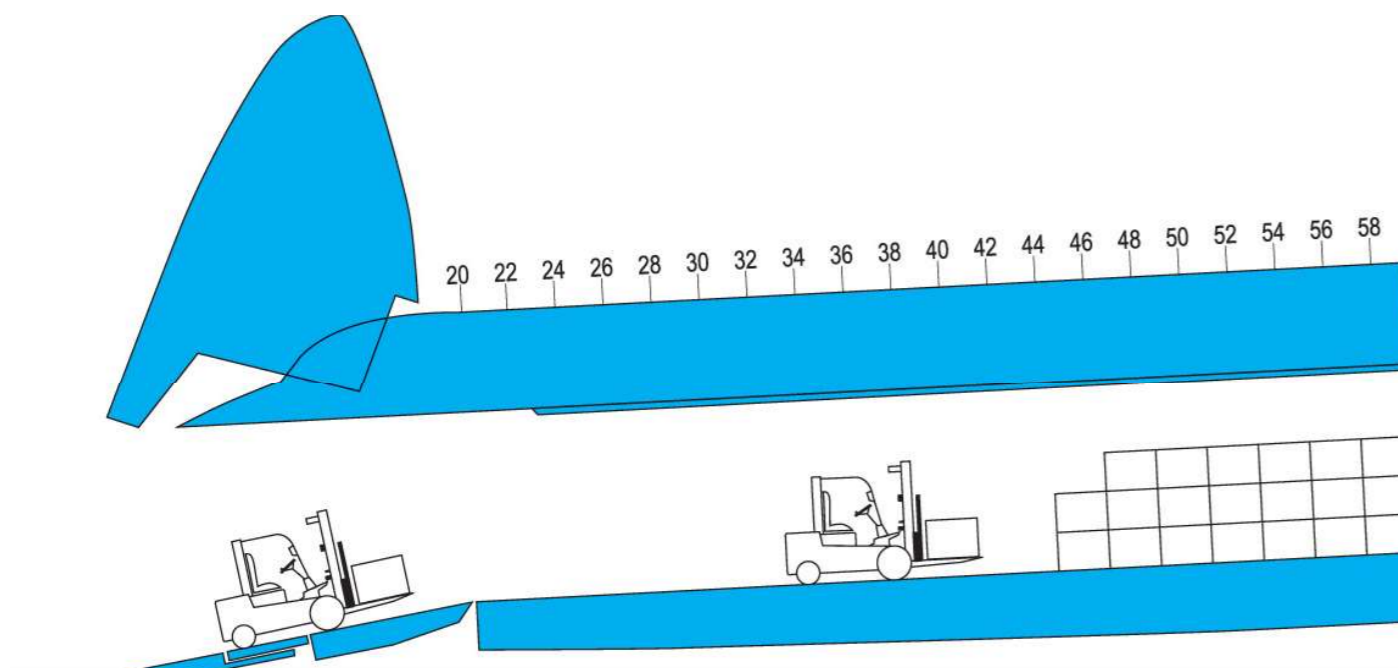



Antonov AN-26-100

AN-26-100 is convertible cargo/passenger twin-engined turboprop aircraft. With a large 2.3 m (7ft 7 in) wide rear cargo door and ramp, cargo can be easily loaded from both the ground or a delivery truck. This expedites the loading and offloading process for the aircraft particularly at locations with minimal aircraft handling facilities.

- The following loading methods are available :**
- Drive-on/off for vehicles.
 - Internal cranes (with a load capacity of up to 2,000 kg (4,409 lbs)).
 - Forklifts (provided by airport handling providers)
 - Hand-operated pallet truck.

Fastening of cargo is carried out using straps, cargo nets and chains.

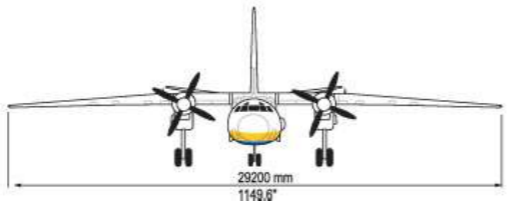
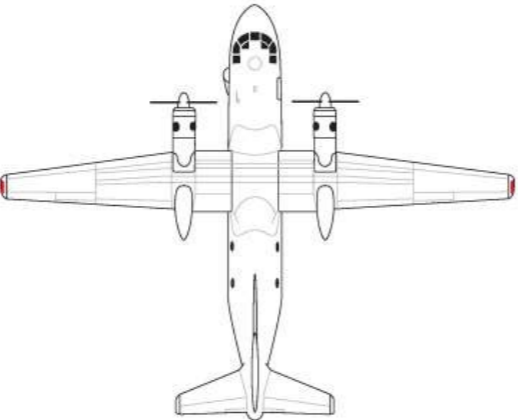
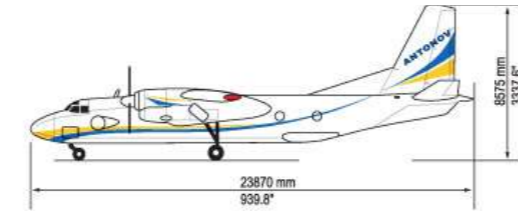

	AN-26-100
Maximum payload	5,000 kg (11,023 lbs)
On-board crane lifting capacity	2,000 kg (4,409 lbs)
Number of passenger seats-up to	18
Cruise speed	440 km/h (273 mph)
Cargo cabin LWH	9 x 2.30 x 1.64 m (354.3 x 94.5 x 64.6 in)



Antonov AN-74T

Antonov Airlines offers passenger charter flights around the world with its AN-74T aircraft. The aircraft has a high-comfort economy class passenger cabin.

The AN-74T is a medium-range passenger aircraft with excellent technical characteristics and can be operated in all geographical areas including to those airfields not always accessible by comparable aircraft. Passenger access is via its own equipped stairs eliminating the need for any portable stairs or jet-bridge – vital when operating to airfields with limited ground support resources.

- Technical characteristics of AN-74T**
- Number of passenger seats – 44
 - Crew, persons: 4+2
 - Cruising speed – 600 km/h (373 mph)
 - Flight range with 44 passengers – 1850 km (1150 mi)

- Specifications:**
- Spacious economy-class seat-pitch in all rows
 - Passenger seats are reclinable
 - Removable rear seat row offering additional baggage stowage when required
 - The galley is located in the aft of the aircraft
 - Spacious overhead luggage compartments
 - Galley area capable of preparing hot meals
 - Wardrobe closet
 - The toilet is located forward of the aircraft
 - Self-sufficient air-stairs for embarkation/disembarkation
 - High-wing and high position of engines allowing operation to unprepared surfaces other comparable aircraft cannot serve

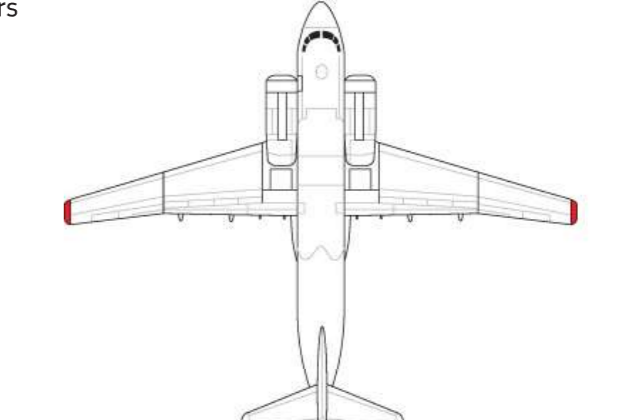
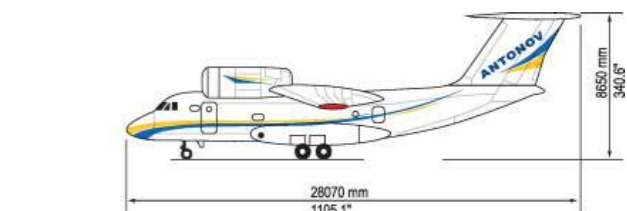

GLOBAL REACH, PERSONAL TOUCH

Antonov Airlines’ global coverage over the last 30 years.

Providing a seamless experience from ground to air, Antonov Airlines puts its customers at the heart of the project no matter how far the distance.

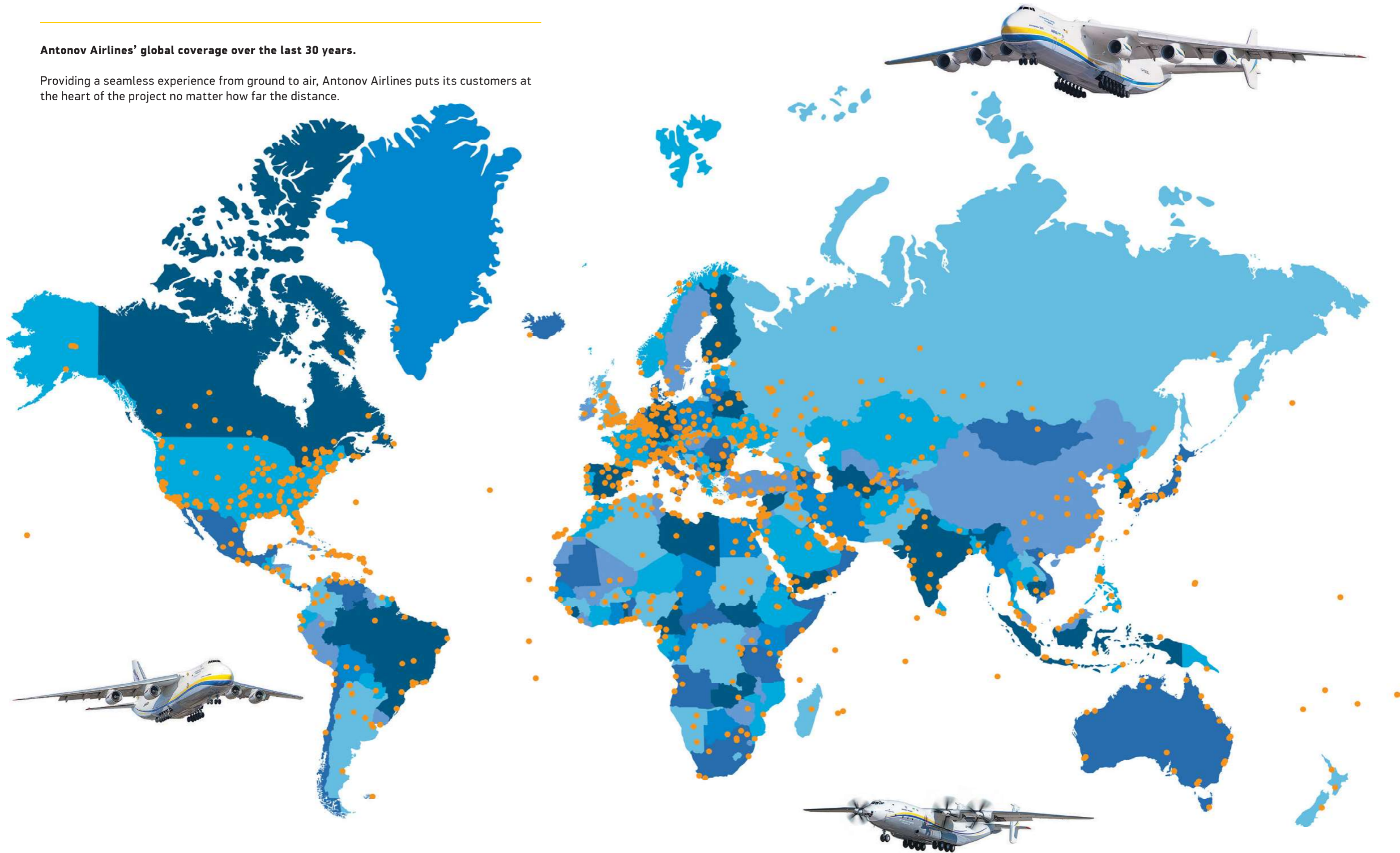

● Airports of the operations of Antonov Airlines fleet



Antonov Airlines – the Record Breaker

- The AN-225 'Mriya', a six-engine aircraft designed on basis of the AN-124 'Ruslan', is a truly unique aircraft. Not only has it set 240 world records, but it is a record-breaker in its own right. The AN-225 is the holder of two Guinness World Records: the aircraft with the heaviest take-off weight; and the largest wingspan of any aircraft currently flying.



- The AN-22 holds its own Guinness World Record. With a wing span of 64.4 m (211 ft 3 in) and a maximum take-off weight of 250,000 kg (550,000 lbs), the AN-22 is the largest propeller driven aircraft ever to enter production. The AN-22 is powered by four 11,030 kW (14,79 hp) contra-rotating turboprop engines and has a cruising speed of 680 km/h (422 mph).



- On September 22, 1993, an Antonov Airlines AN-124-100 carried the heaviest single piece of cargo, flying a 135,200 kg (298,065 lbs) power plant stator generator with transport frame from Dusseldorf, Germany, to New Delhi, India, setting a Guinness World Record.



- On September 11, 2001, during one flight, the AN-225 set 214 national and 124 world records, including the transportation of the heaviest payload ever airlifted, at 253,820 kg (559,577 lbs).



- On June 16, 2004 the AN-225 set six world records, including a new payload record for an aircraft when it took off from Prague, Czech Republic carrying a commercial payload of 247,000 kg (544,542 lbs) to Tashkent.



- On August 11, 2009, the AN-225 carried the heaviest single piece in the history of aviation. A generator and loading frame weighing a total of 187,600 kg (413,587 lbs) was transported from Frankfurt, Germany, to Yerevan, Armenia. The transportation found its way into the Guinness World Records.



- The following year, on June 11, 2010, the AN-225 carried the world's longest piece of air cargo – two 42.1 m (137 ft 9.5 in) test wind turbine blades from Shijiazhuang, China, to Skrydstrup, Denmark.



- On September 27, 2012, the AN-225 broke another Guinness World Record for the highest altitude art exhibition, at 10,150 m (33,300 ft) above sea level. The airborne exhibition included 500 works of art created by 120 artists.



- In November 2016, Antonov Airlines performed the air transportation of a 155-tonne transformer from São Paulo, Brazil, to Santiago, Chile. The total payload (including packaging) was 182,000 kg (401,241 lbs). It was the world's second heaviest single piece transported by air, and the heaviest piece carried in Americas by air.



KEY DATA



UKRAINIAN
OPERATOR

The international
air transportation division
of Antonov Company



FOUNDED
1989

The first to offer the
AN-124-100 commercially



OPEN
24/7/365

Flying 365 days a year



SOLE
OPERATOR OF
AN-225 and
AN-22

The one-and-only,
world record-breaker



UKRAINE-US
OPEN SKIES
AGREEMENT

Exercising fifth freedom
traffic rights to and from
the US since 2015

WHY CHOOSE ANTONOV AIRLINES?

- You can load more – we are the only operator of the certified AN-124-100M-150 aircraft, offering an increased payload of up to 150,000 kg (330,693 lbs);
- You will benefit from unrivalled and unsurpassed experience – we created, developed and continue to lead the AN-124 transportation market;
- We are the world’s only airline to offer payloads ranging from 5,000 kg (11,023 lbs) to 250,000 kg (551,156 lbs);
- Your valuable cargo will be safely transported within hours or days, saving you time and potentially cost;
- You will be provided with round-the clock communication;
- We are the only airline to use a Flight Manager on each aircraft, providing you with a dedicated point of contact during loading and offloading of cargo.
- You will enjoy a seamless experience – from quotation through to delivery, you will be guided by the same project manager, providing a holistic approach to every operation;

With dedicated professionals accompanying you and your shipment on the ground and in the air, all supported by an unrivalled technical expertise, Antonov Airlines provides a **GLOBAL REACH with a PERSONAL TOUCH**. Quite simply, we are unlike any other – because **‘No Other Name Carries More Weight’**.



ANTONOV AIRLINES
NO OTHER NAME CARRIES MORE WEIGHT



Headquarters

1, Akademika Tupoleva Str.
Kyiv, 03062, Ukraine
Tel.: +380 44 454 0204
+380 44 454 0205
Fax: +380 44 454 2852
E-mail: sales@antonov-airlines.com
www.antonov.com

UK office

Endeavour House, Coopers End Road
London Stansted Airport, CM24 1SJ,
United Kingdom
Tel.: +44 (0) 1279 912 291
Fax: +44 (0) 1279 219 975
E-mail: sales@antonov-airlines.com
www.antonov-airlines.com

USA office

Antonov Airlines Inc
11811 North Freeway, Suite 500
Houston, Texas 77060, USA
Tel.: +1 (281) 436 7323
+1 (281) 436 7326
E-mail: salesna@antonov-airlines.com