

SGBAC

SEOUL GIMPO
BUSINESS AVIATION CENTER

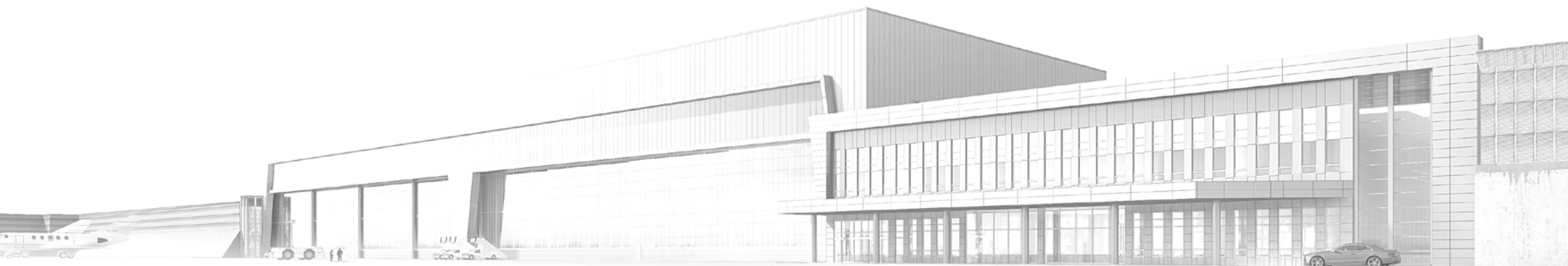



CONTENTS

01 About Us	04	06 Spacious Parking Stands.....	16
02 Location	08	07 Sufficient Slot Capacity.....	17
03 Executive Terminal	12	08 Company Contact	18
04 Maintenance Service	14	09 SGBAC Usage Fees.....	19
05 Hangar	15	10 Seoul-The Beloved World City	20

01



About Us

Seoul-Gimpo Business Aviation Center

made its debut in 2016 as the nation's first dedicated business aviation services facilities.

Located at Gimpo International Airport, the facilities are owned by the airport operator, Korea Airports Corporation(KAC), a government-owned company which manages and operates fourteen airports throughout the country.

The facilities are comprised of an executive terminal and 12,490m² of hangar that can accommodate up to eight G550 or Global 6000 simultaneously.

The terminal and a part of the hangar are directly managed by KAC, with the remaining maintenance hangar area managed by KBAS, a leading company in global business aviation.

As the best spot for international corporate jets to get to and from Asia, we will commit to providing our valued customers with the safest and highest quality of services.



Korea's First Business Aviation Center



02

> Location

Hub of Asia

SGBAC is situated as the hub of Asia-Pacific region. It is a convenient transit spot connecting other major cities like Tokyo or Beijing less than a two-hour flight.

Flight Time	Destinations
In 2 Hours	Tokyo, Osaka, Beijing, Shanghai, Taipei, etc.
In 4 Hours	Manila, Hongkong, Hanoi, Chongqing, Xian, etc.
In 6 Hours	Singapore, Kuala Lumpur, Bangkok, New Delhi, Almaty, etc.
In 8 Hours	Mumbai, Jakarta, etc.
In 10 Hours	Hawaii, Brisbane, Sydney, Abu Dhabi, Dubai, etc.



Easy Access to Heart of Seoul

Located at Gimpo International Airport and only 17 Km from the heart of down town Seoul, SGBAC offers passengers a quick and easy access into the city center for various business occasions and vibrant cultural attractions.

Transportation Options

Transport Mode	Travel Time (to Gangnam)
Helicopter	15~20 minutes (BAC↔Jamsil Heliport)
Car & Bus	60 minutes
Subway	30 minutes (Subway Line 5,9 and Airport Railroad)

Only **17km** away from downtown Seoul

Gimpo International Airport

Sungnyemun (Namdammun)

Seoul Station

Myeongdong

Dongdaemun Shopping Town

Lotte World Adventure

COEX

Yeouido Finance Center

63 Square

Gangnam Station

Ultimate Care From Touch Down To Take Off



03



Executive Terminal



Luxurious VIP Lounge

SGBAC, as a dedicated and exclusive terminal for business jets, offers a high degree of privacy and comfort for all VIP guests visiting the center.

Discover our spacious VIP lounge, fully equipped private meeting rooms and etc.



CREW LOUNGE

A separate crew lounge is provided for crew members to relax and prepare for their next flight in a comfortable and pleasant condition.

- PCs with access to the internet
- Comfortable lounge chairs and bed
- TV, magazines and entertainment
- Tea & coffee, light refreshment



Speedy CIQ Clearance

Exclusive CIQ(Customs, Immigration, Quarantine) Control at SGBAC will allow the passengers to experience a speedy entry/exit process.

- Immigration and Customs on site
- Hassle-free and efficient process

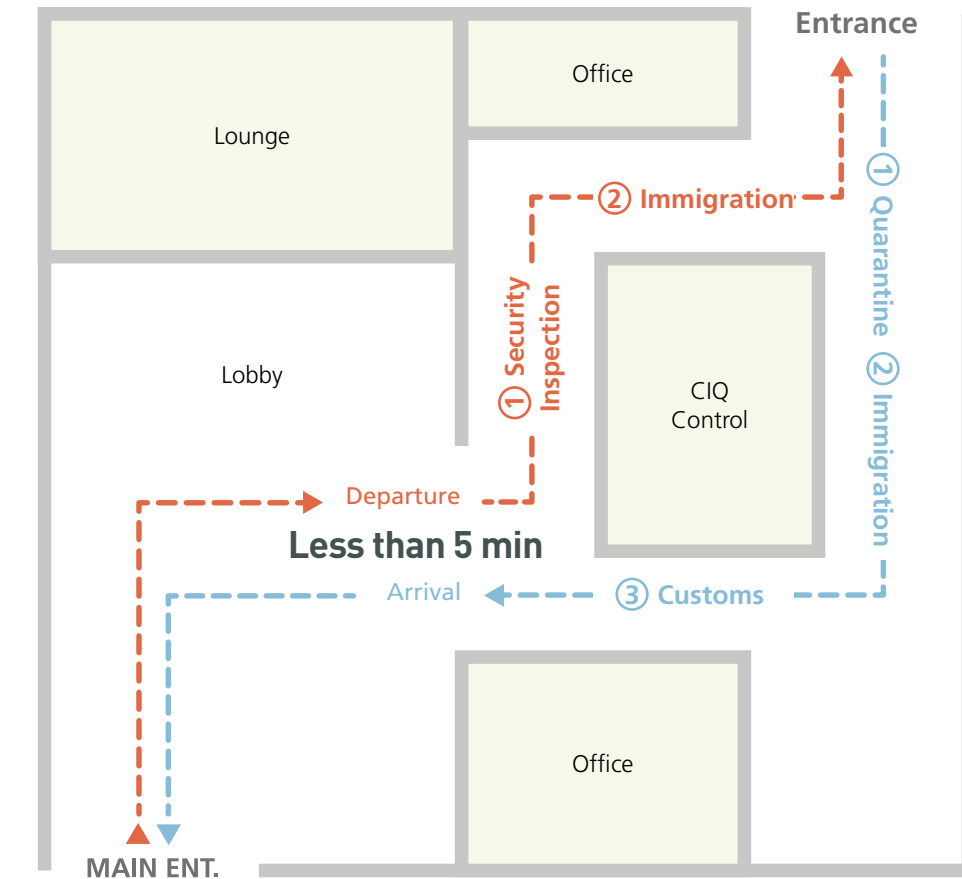

06



Spacious Parking Stands

Expanded apron and ample parking stands lying in front of SGBAC welcome all kinds of business jets.

7 Dedicated parking stands for business aviation are located right in front of the SGBAC building. If business aircraft parking is full there are 70 other parking stands available at Gimpo International Airport, with no restriction on parking period.



07



Sufficient Slot Capacity

Gimpo International Airport, less congested with surplus slots, guarantees the on-time operation throughout the operational hours.

- Average slot utilization rate in 2015 : 63.2%
- At least 15 more slots available per hour

Runway Specification

length x width	Direction	Category	Minimum Landing Visibility	Capacity
3,600 × 45m	14L	CAT- I	RVR 550m	41 movements/hr (*peak time('15) : 37 movements)
	32R	CAT- I	RVR 550m	
3,200 × 60m	14R	CAT- III a	RVR 175m	
	32L	CAT- I	RVR 550m	



08

>

Company Contact

Company	Contact Info
KBAS (Korea Business Air Service)	+82-32-744-3443~5 www.kbas.com kbas@kbas.com

09

>

SGBAC Usage Fees

Business Aviation Center Usage Fees will be charged to those who use the SGBAC terminal or business aircraft storage hangar(operated by Korea Airports Corporation).

Type	Usage Fees		
	Criteria for Imposing Usage Charges		Rate
Terminal Usage Fee	① Basic Charge	<ul style="list-style-type: none">○ Per Flight (with less than 10 passengers)<ul style="list-style-type: none">- Each arrival and departure is counted as 1 flight.<ul style="list-style-type: none">▷A round trip is counted as 2 flights.- Same charges apply to international and domestic- Charges are applied the same up to 10 passengers	550,000 KRW
	② Additional Charge	<ul style="list-style-type: none">○ Per 1 Additional Passenger (After exceeding 10 passengers)<ul style="list-style-type: none">- Added to the basic charge : ① + ②	55,000 KRW
	③ Ferry flight	<ul style="list-style-type: none">○ 50% of ① / per flight<ul style="list-style-type: none">- Same Criteria as ① is applied	275,000 KRW
	④ VIP Room Usage Charge	<ul style="list-style-type: none">○ Per 1 Additional Hour<ul style="list-style-type: none">- After exceeding 1 complimentary hours- Time less than an hour are counted as 1 hour	150,000 KRW
Hangar Usage Fee	<ul style="list-style-type: none">○ Per Ton / Per Hour<ul style="list-style-type: none">- Charged based on MTOW- Charges are imposed upon the starting time indicated on the application- Time less than an hour are counted as 1 hour- Units less than 10 KRW will be deducted from the charges.		1,719 KRW

- ※ V.A.T. will be separately charged.
- ※ For departing passengers, Departure Tax and Contribution to International Poverty Eradication will be charged separately.
- ※ In case of the user has cancelled or made changes to the use of Business Aviation Center after the usage fees have been collected, the usage fees will be re-calculated to refund the differences or collect additional charges. The differences will be refunded only upon the request of the applicant.
- ※ The same charges will be applied in case of transfers using other aircraft.

10



Seoul – The Beloved World City

Seoul has served as the nation's capital for more than 600 years. Today, Seoul is a bustling metropolis, acting as the political, economic and cultural hub.

General Information

- **Area** : 605.25 km²
- **GDP** : \$774 billion
- **Population** : 10.1 million('15)

Seoul, Where the Business Begins

- South Korea, the 5th Business-friendly Country in the World (World Bank, 2015)
- World's leading information & communication technology



International Recognitions & Awards

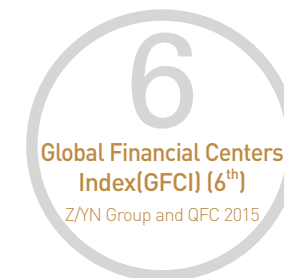
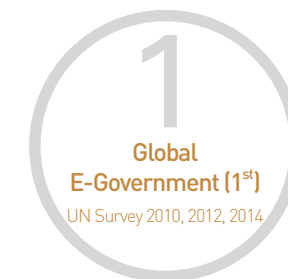



Business Flying High with SGBAC